



Chuffy Train

(UK) Symbols in these instructions. (FR) Symboles des instructions. (ESP) Símbolos en estas instrucciones. (IT) Simboli in queste istruzioni. (Ger) Symbole in dieser anleitung



(UK) Waiting time.
(FR) Temps d'attente.
(ESP) Tiempo de espera.
(IT) Tempo d'attesa.
(DE) Wartezeit.



(UK) Wax surface to lubricate.
(FR) Appliquer la cire sur cette surface.
(ESP) Aplica la cera sobre esta superficie.
(IT) Applicare la cera su questa superficie
(DE) Wax Oberfläche zu schmieren.



(UK) Glue.
(FR) Coller.
(ESP) Pegar.
(IT) Incollare.
(DE) Leimen



(UK) Don't glue.
(FR) Ne pas coller.
(ESP) No pegar.
(IT) Non incollare.
(DE) Nicht leimen.



(UK) Glue guard. Prevents glue getting between moving parts during build. Remove after 2 minutes.
(FR) Piece de protection contre la colle. Pendant l'assemblage, eviter tout dépôt de colle sur les pieces en mouvement. Enlever apres 2 minutes.
(ESP) Parte de protection de el pegamento. Durante la fase de embalaje, evitar que el pegamento se ponga sobre partes que se mueven. Quitar despues de dos minutos .
(IT) Pezzo di protezione della colla. Durante l'assemblaggio evitare che la colla vada su parti non statiche . Imuovere dopo due minuti.
(DE) Karton. Verhindert das eindringen von leim zwischen die bewegliche teile während der montage. Zwischen die beweglichen Teile.

Helpful hints/conseils utiles/consejos utiles/suggerimentutili/nützliche tipps

- (UK) Check all parts present in trays
(FR) Vérifier que toutes les pièces soient présentes dans les bacs
(ESP) Controlar que hay todas la partes en la caja
(IT) Controllare tutte le parti presenti nel kit
(DE) Bitte prüfen sie, ob alle benötigten teile vorhanden sind
- (UK) Read all instructions and look at all diagrams
(FR) Lire toutes les instructions et regarder toutes les figures
(ESP) Leer las intrucciones y guardar a los diagramas
(IT) Leggere tutte le istruzioni e guardare i diagrammi
(DE) Lesen sie alle anweisungen und betrachten sie die schaubilder
- (UK) Check assembly before gluing
(FR) Vérifier le montage avant collage
(ESP) Controlar el montaje antes de empezar a pegar
(IT) Controllare l'assemblaggio prima di incollare
(DE) Montage prüfen vor dem einklebern
- (UK) Some parts may need sanding
(FR) Certaines pièces nécessiteront d'être poncées.
(ESP) Algunas parte necesitan de ser suavizadas
(IT) Alcune parti potrebbero aver bisogno di levigatura
(DE) Möglicherweise müssen manche teile geschliffen werden

Colouring tips/conseils concernant l'application de peinture/ consejos para Pintar/ suggerimenti per colorare/ lackiertipps

- (UK) Do not apply paint to parts which move against one another. It is easier to paint some parts before assembling
(FR) Ne pas appliquer de peinture sur les parties qui se déplacent l'une contre l'autre. Il est conseillé de peindre avant assemblage
(ESP) No aplique la pintura sobre las partes que se tocan. Resulta mas facil pintar las partes antes de montar.
(IT) Non applicare la pittura su quelle parti dove ce attrito con un'altra parte. è piu semplice pitturare alcune parti prima della fase di assemblaggio.
(DE) Teile, die aneinander reiben, sollten nicht lackiert werden. Fertig lackierte teile sind off leichter zu montieren

New Symbols in our Instructions



Visit our website to view instructional videos where you see this symbol.

www.timberkits.com



Pay special attention to this section.

NEED ADVICE?



If you need help or advice you can call our
Timberkits Human Support System!

Luise Willis

01650 521635

Or you can visit our website for tips, advice and instructional videos. All
these can be found in Resources/Advice Videos on our website.

www.timberkits.com

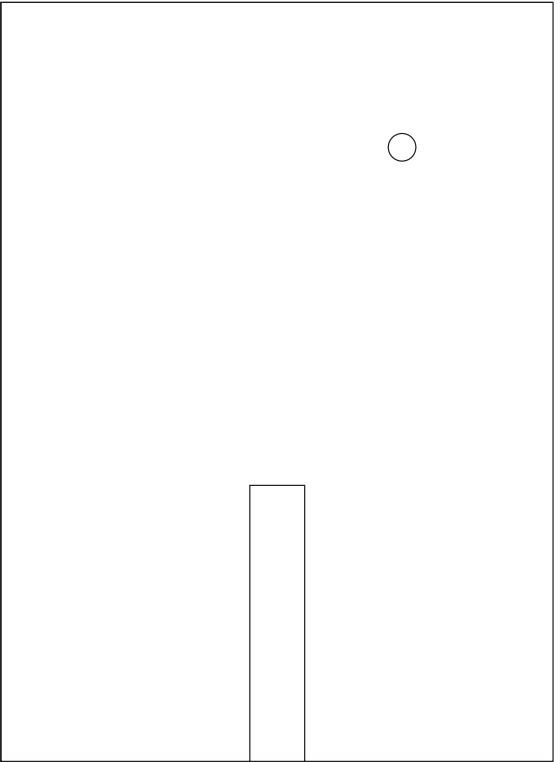

12 & 14

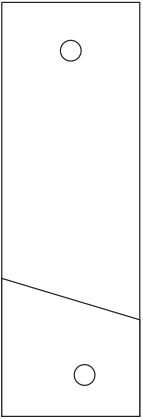

17

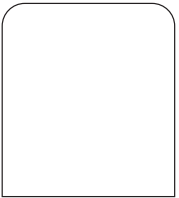

40

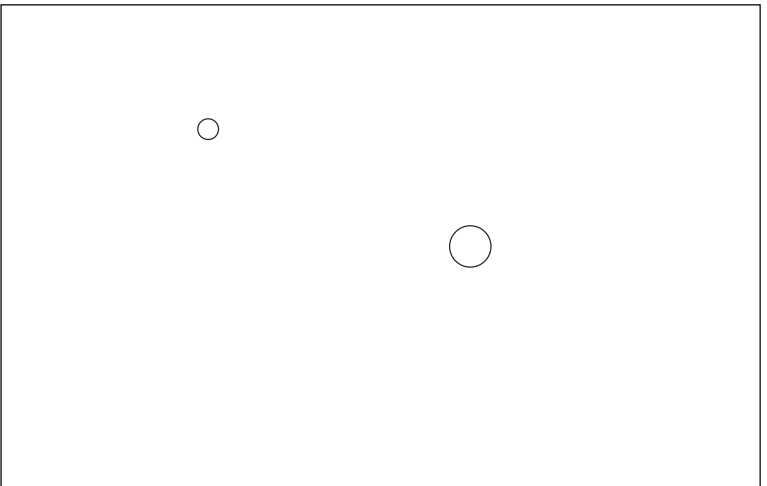

4 & 13

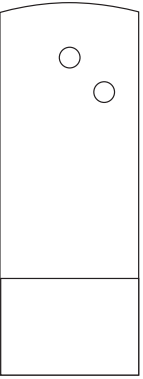

18



20

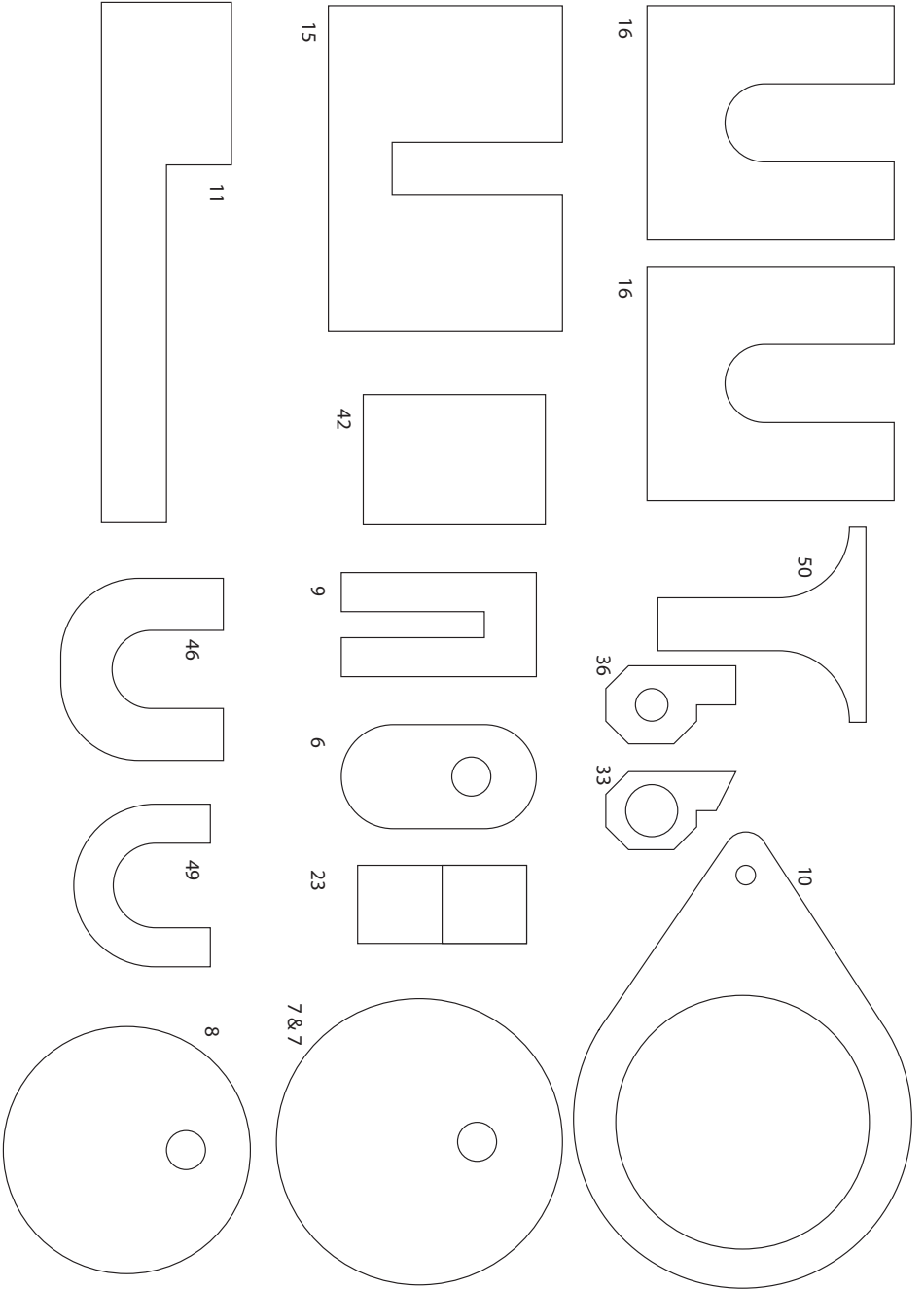

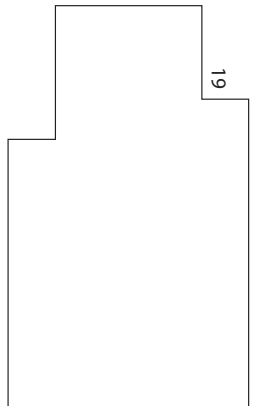
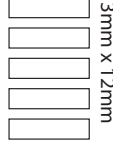
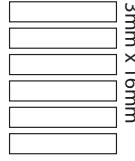
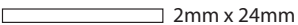
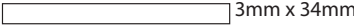
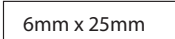
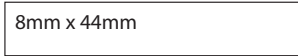
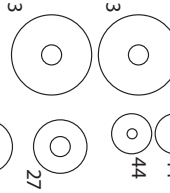
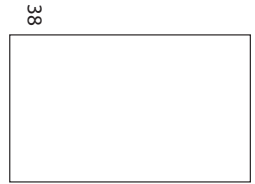
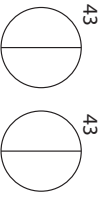
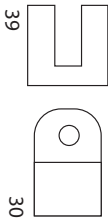
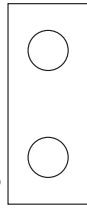
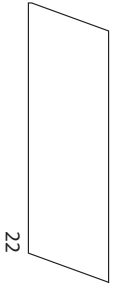
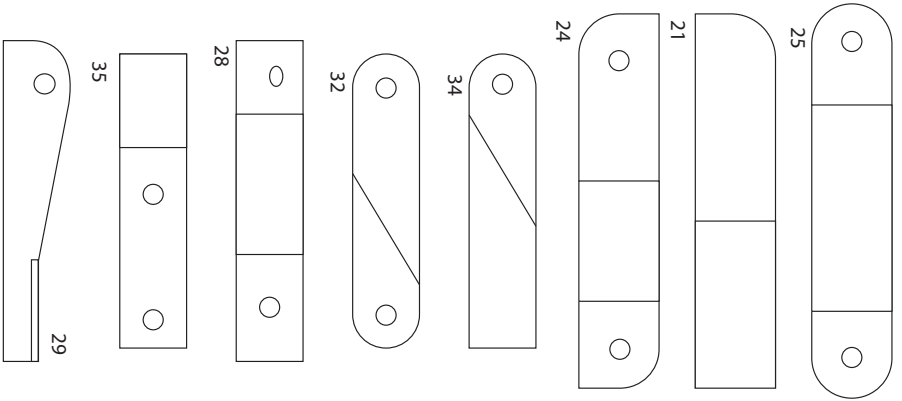

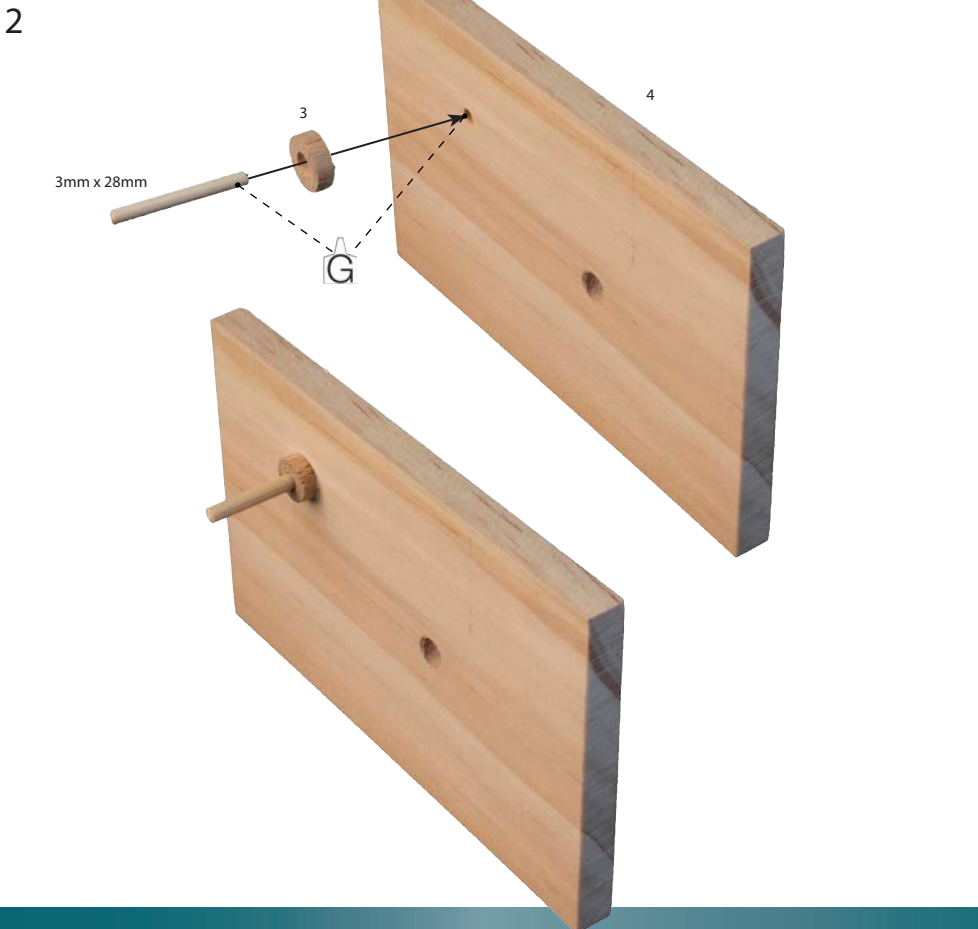
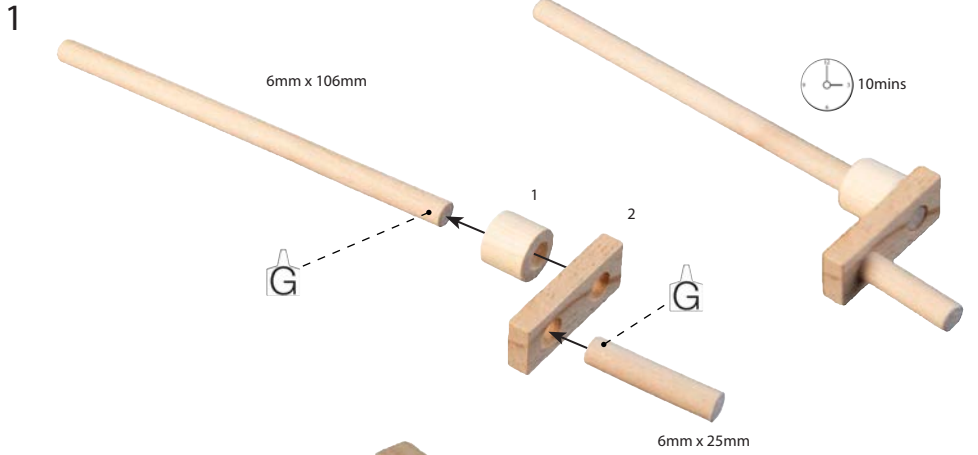

3

3a

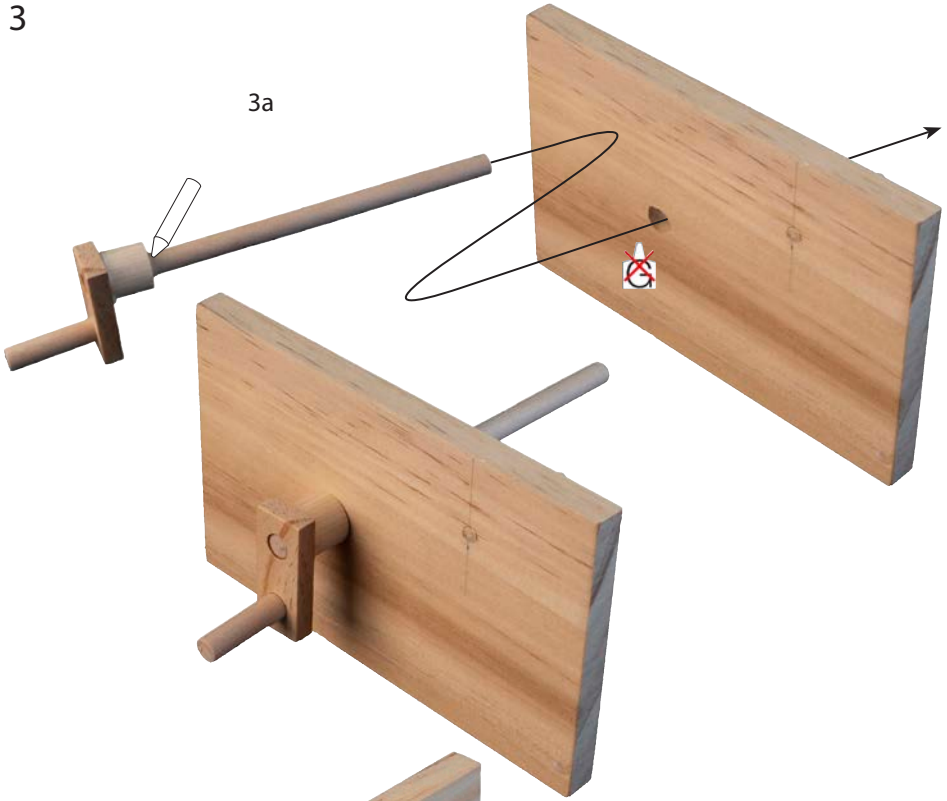

3b

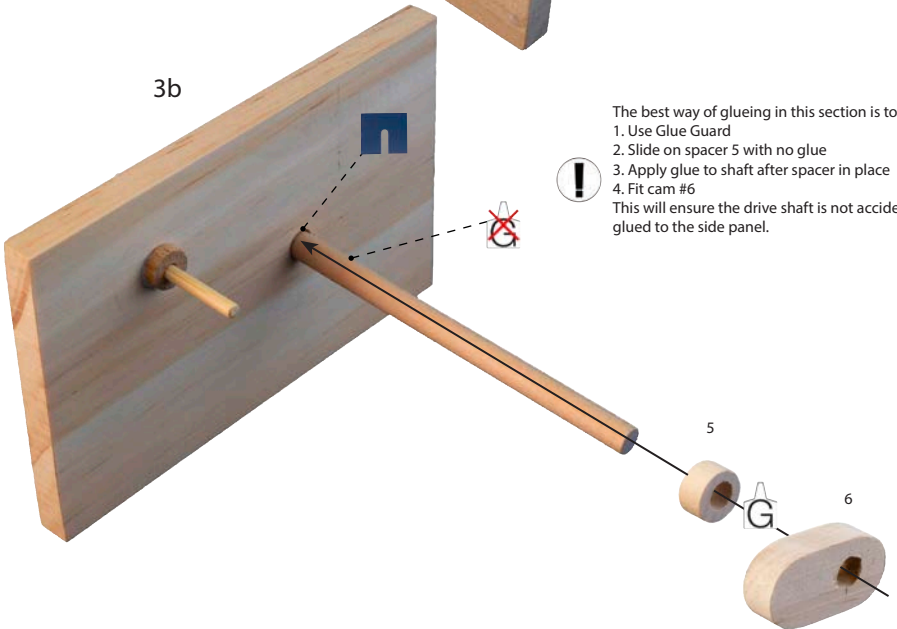

The best way of glueing in this section is to...

1. Use Glue Guard
2. Slide on spacer 5 with no glue
3. Apply glue to shaft after spacer in place
4. Fit cam #6

This will ensure the drive shaft is not accidentally glued to the side panel.

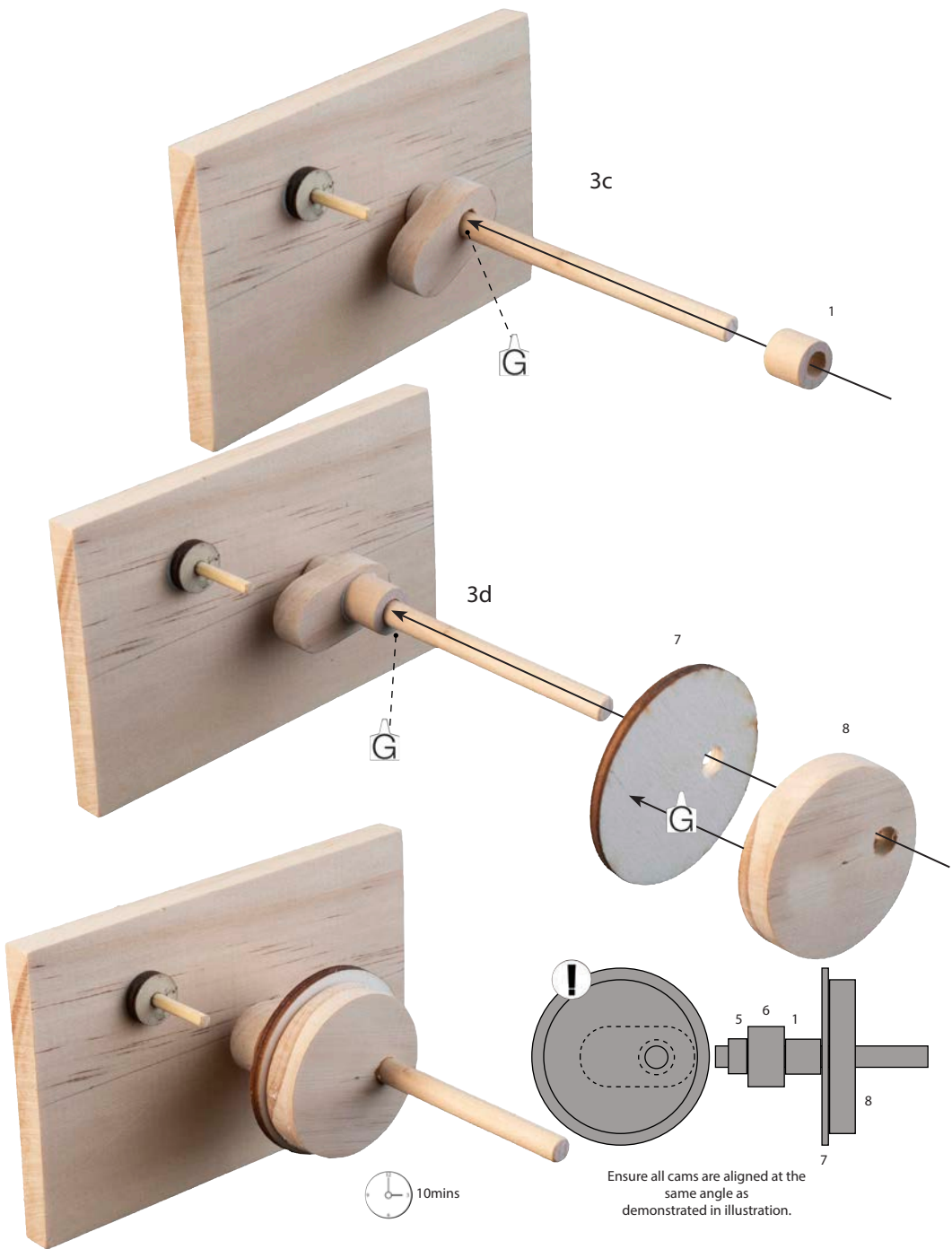

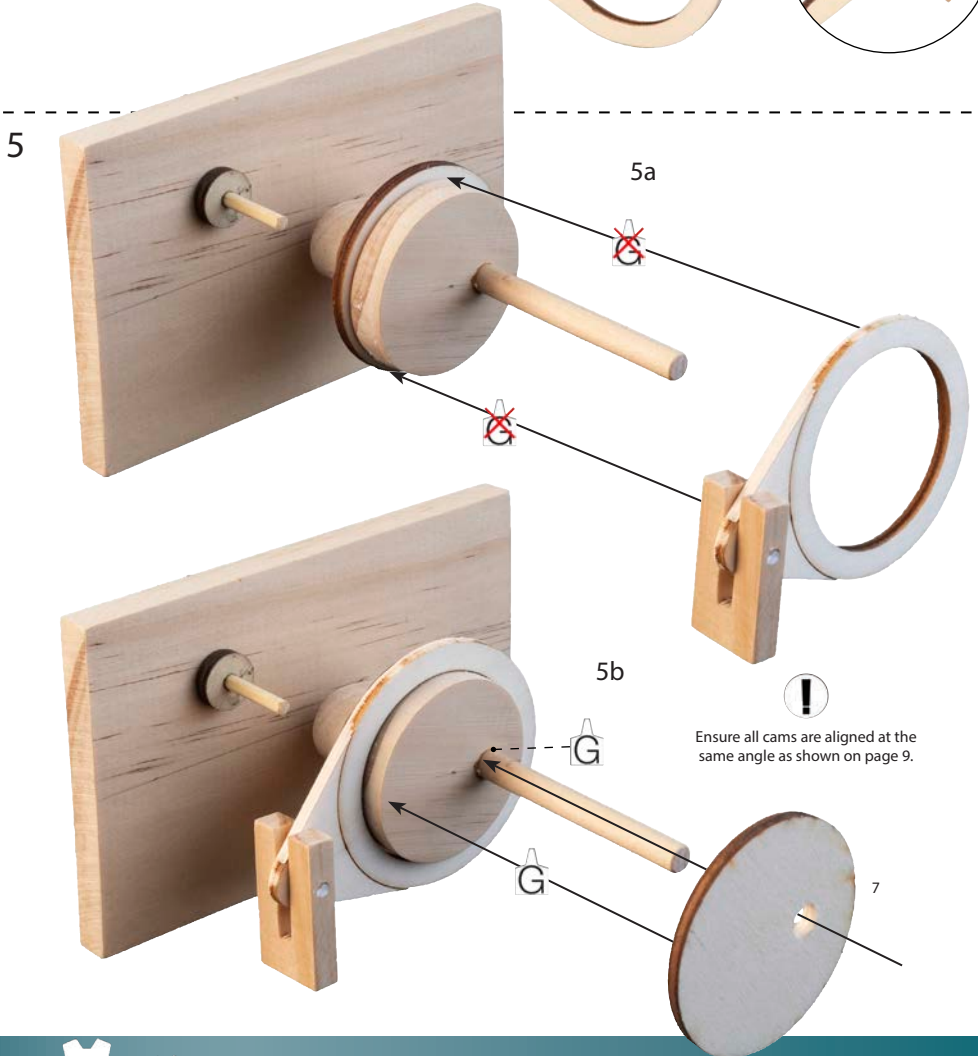
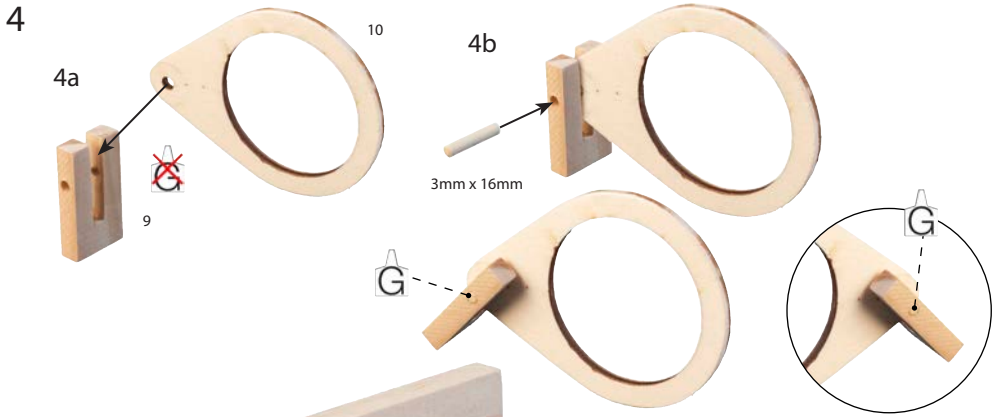

6

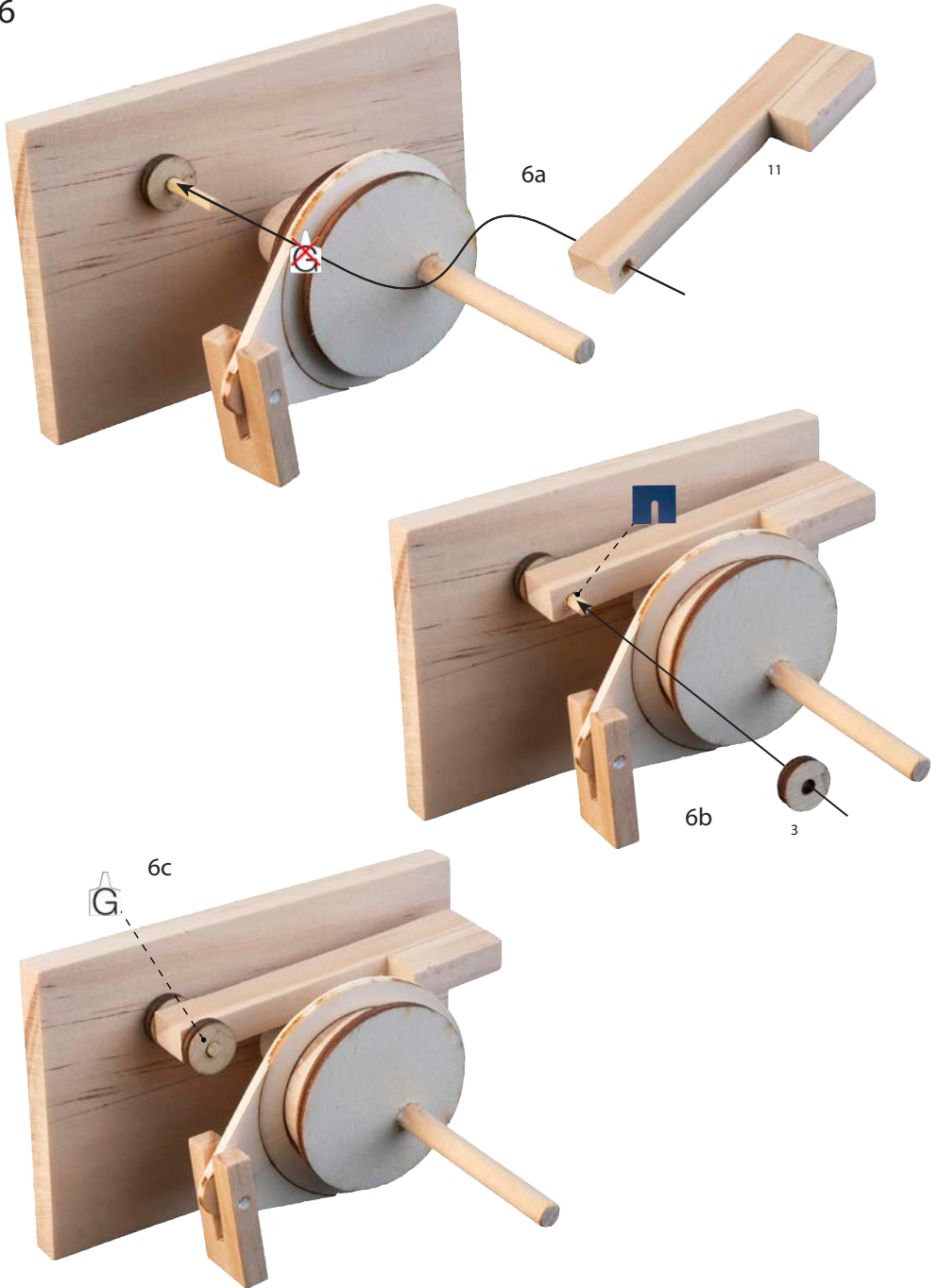

7

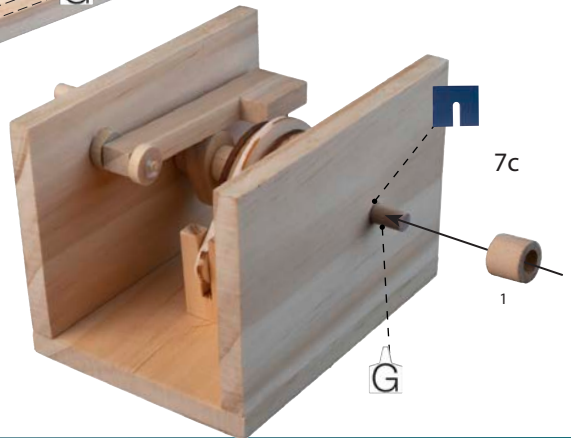
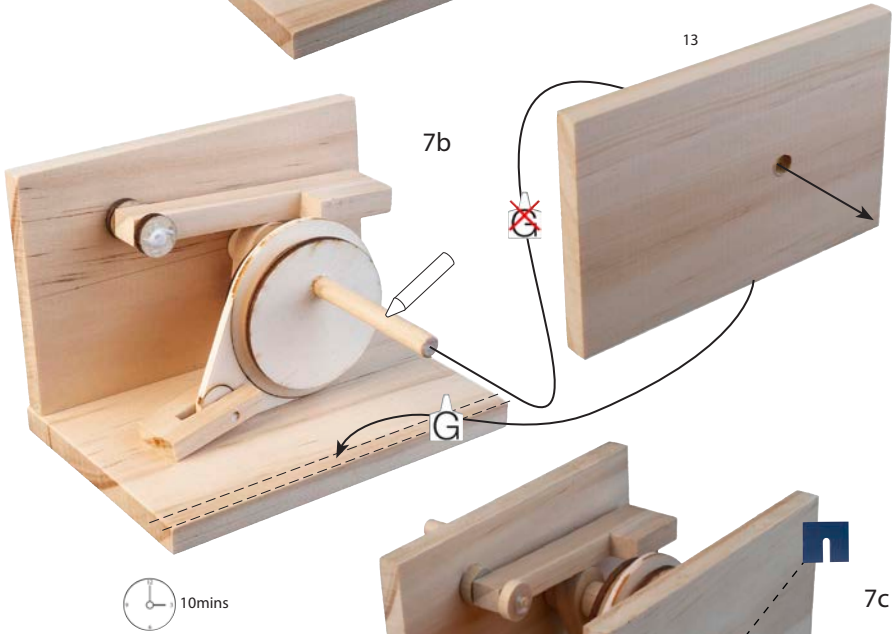
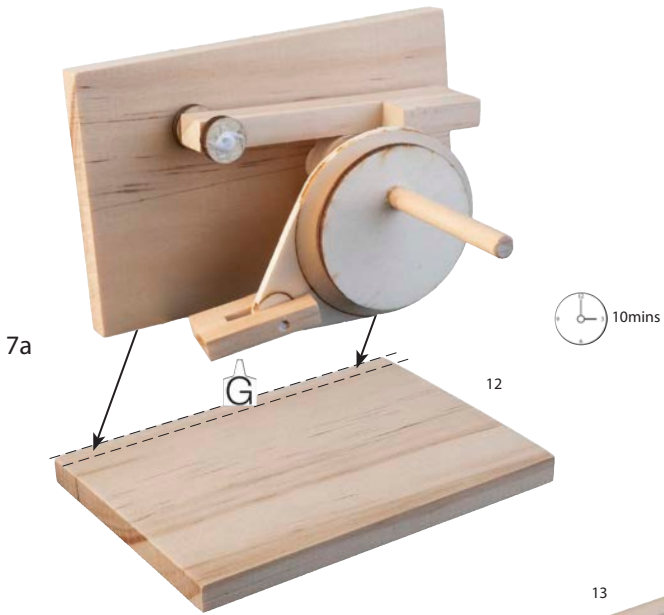

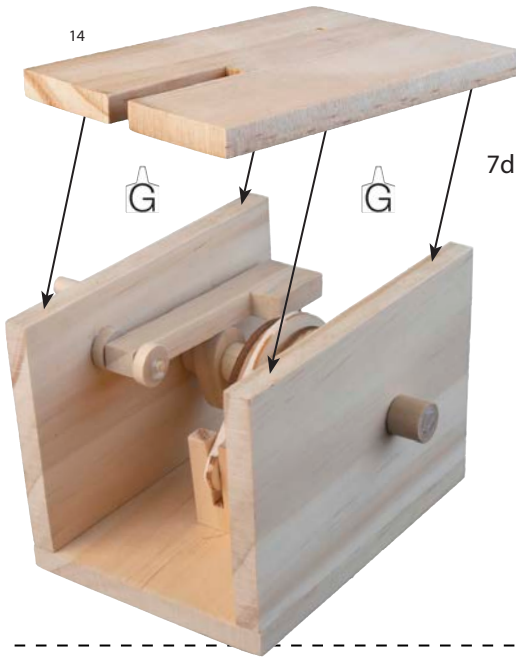

8

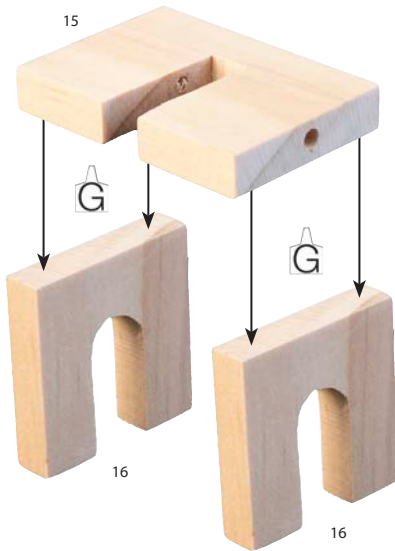

9

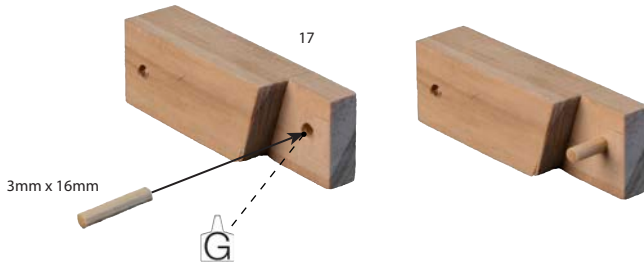

10

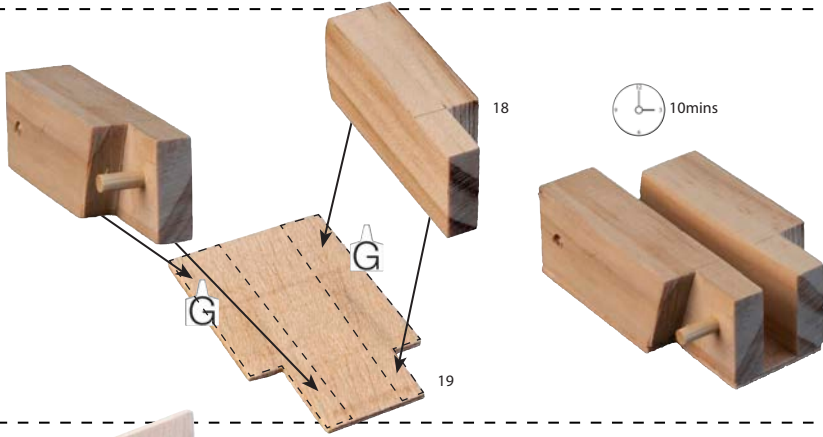

11

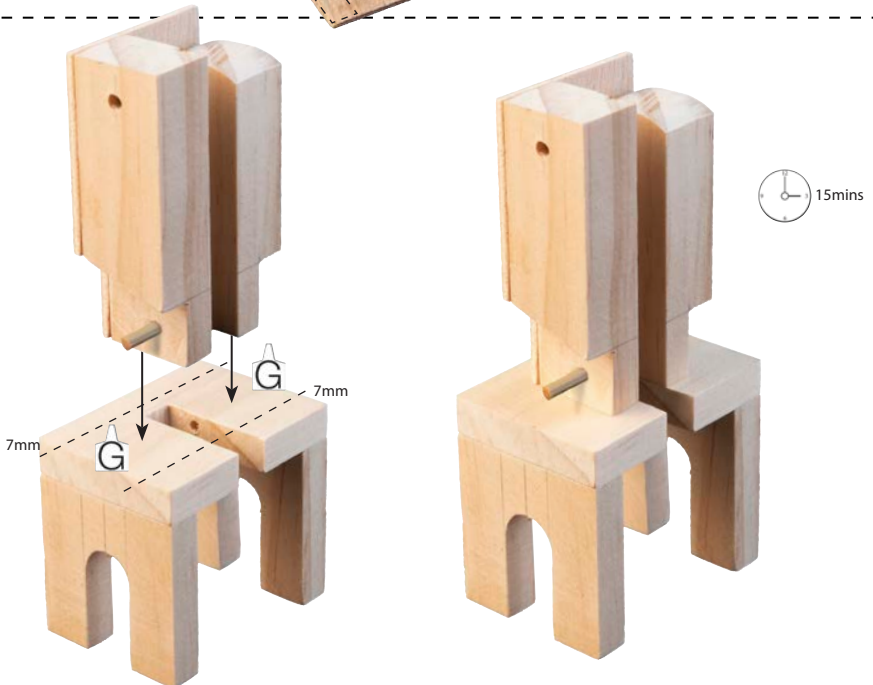

12



13

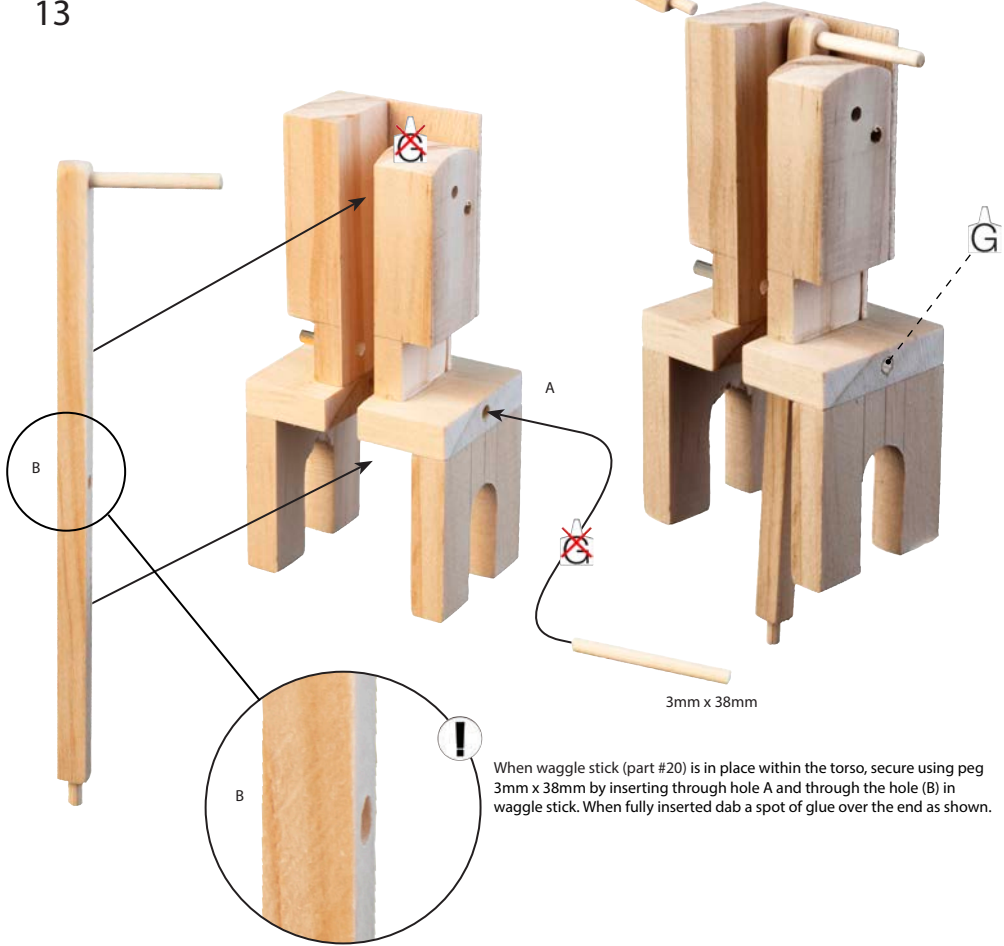

When waggle stick (part #20) is in place within the torso, secure using peg 3mm x 38mm by inserting through hole A and through the hole (B) in waggle stick. When fully inserted dab a spot of glue over the end as shown.

14

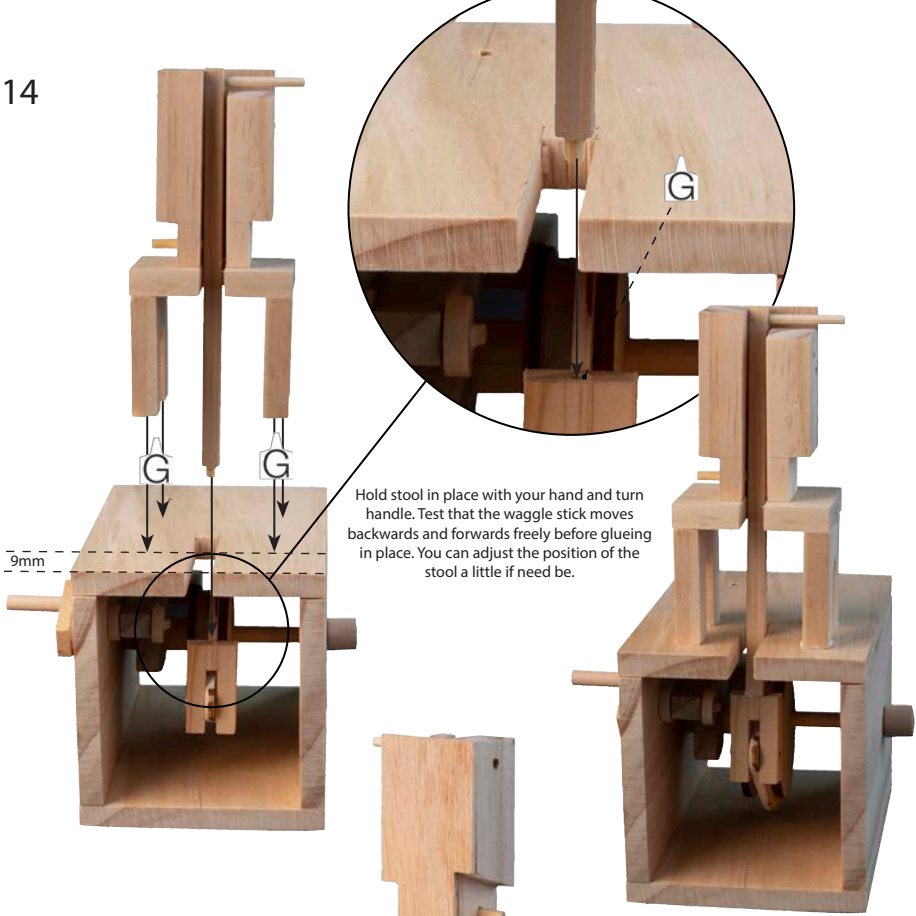

Hold stool in place with your hand and turn handle. Test that the waggle stick moves backwards and forwards freely before glueing in place. You can adjust the position of the stool a little if need be.

9mm



15mins

15

15a

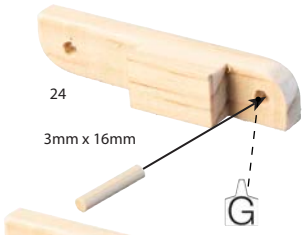

21

15c

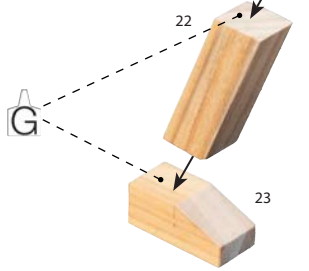

24
3mm x 16mm



15b

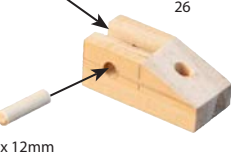
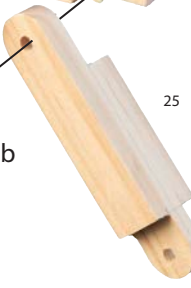

3mm x 12mm

15d

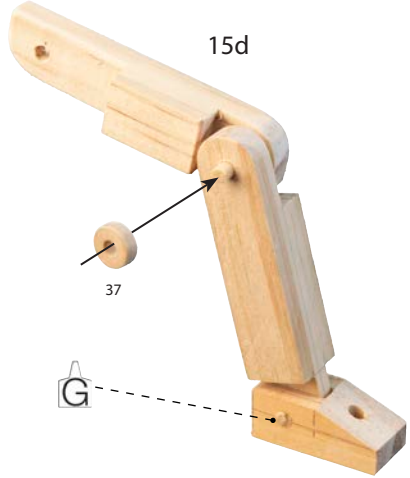

15e

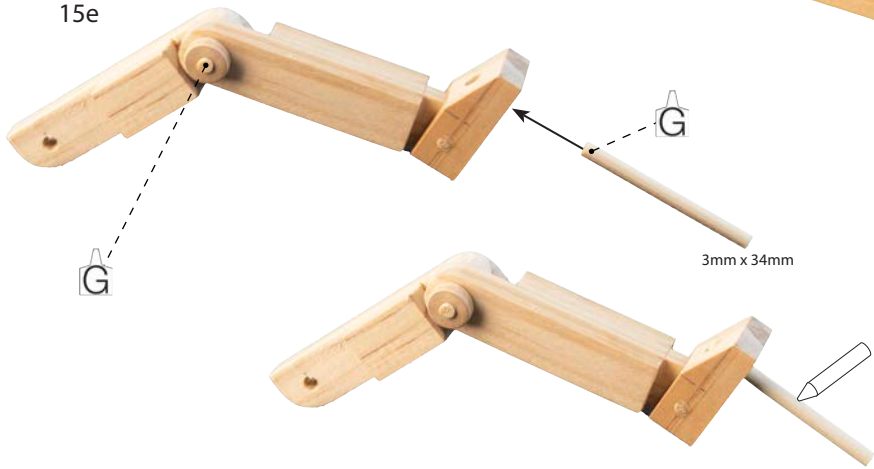

16

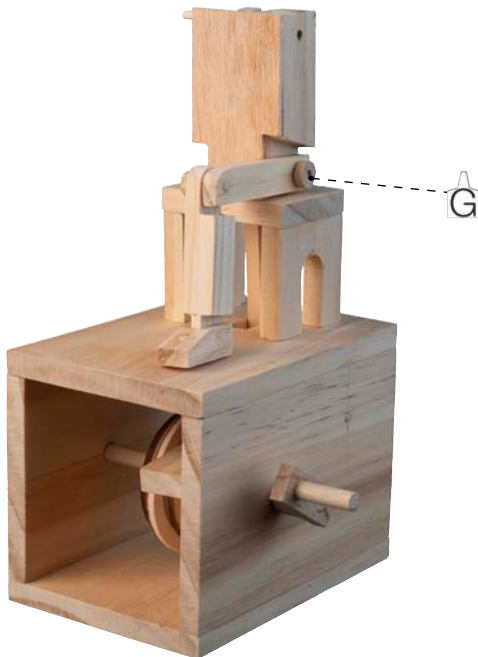
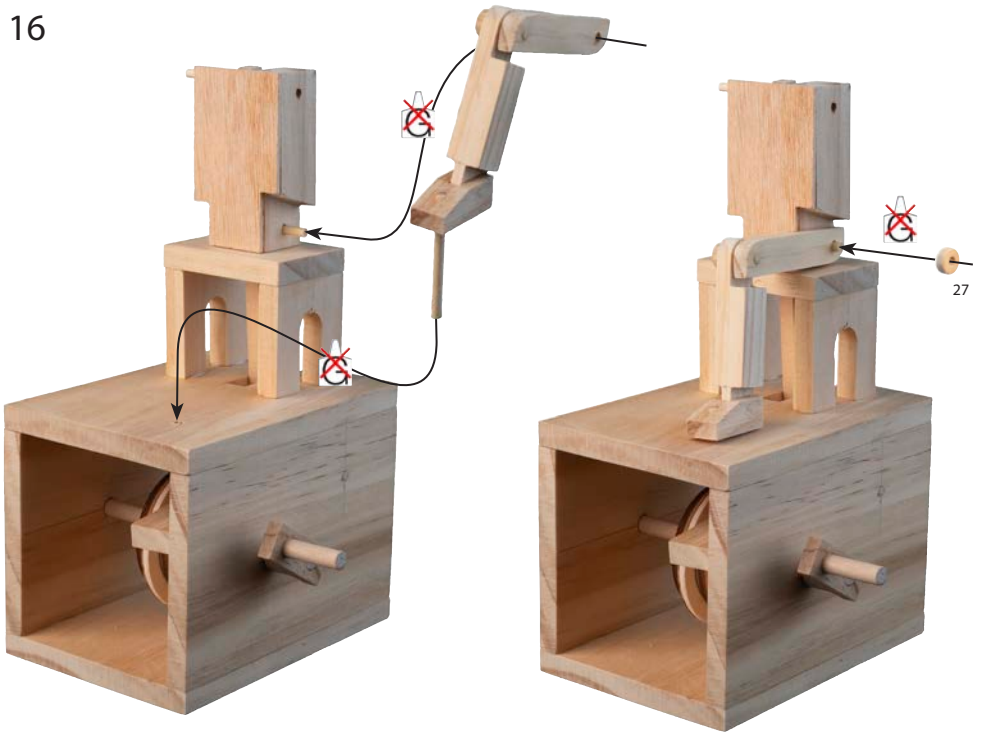

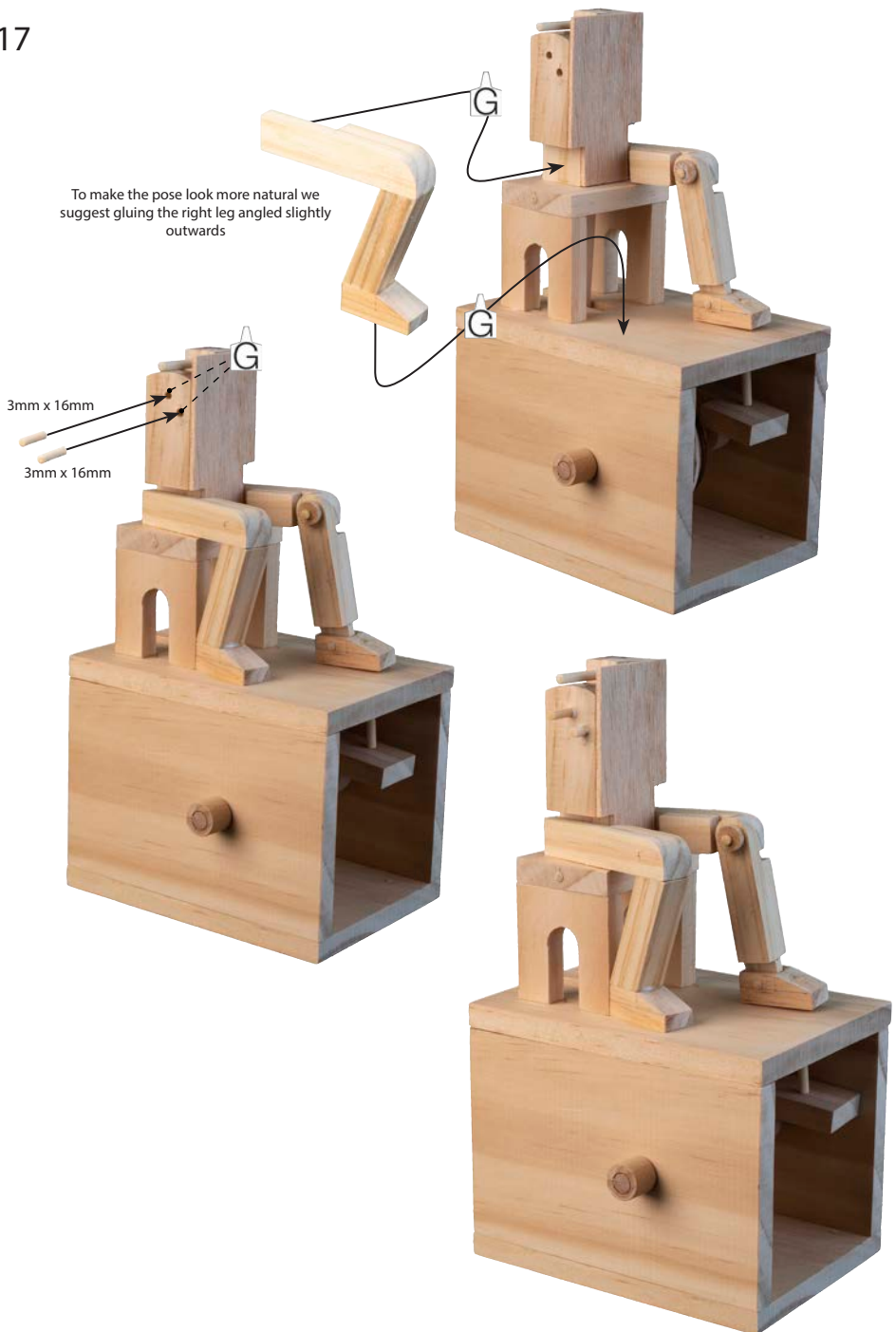

18

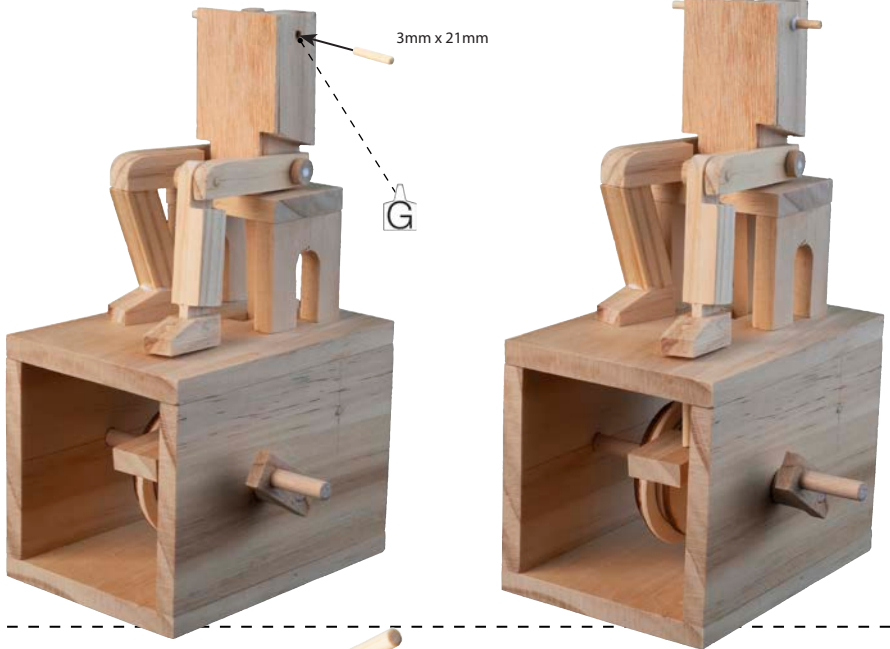

19

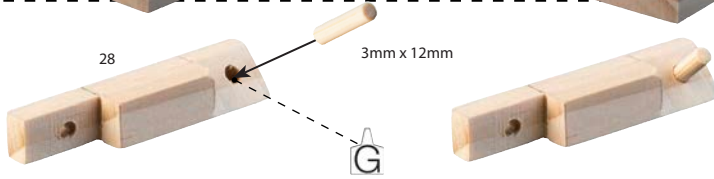

20

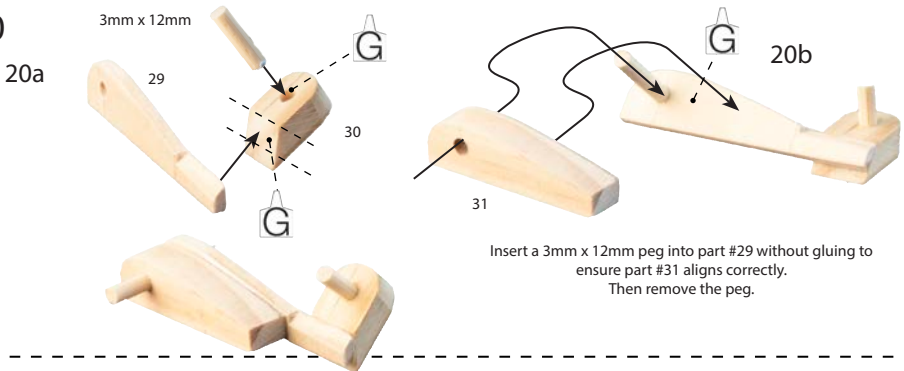

21



22

22a

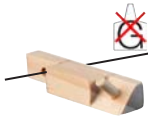

22b



G

22c



22d



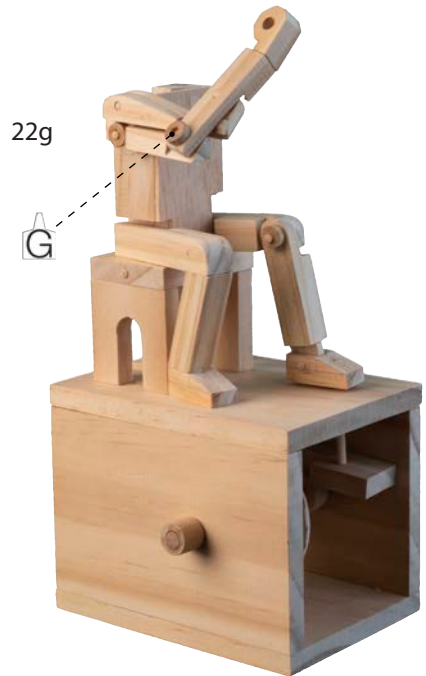
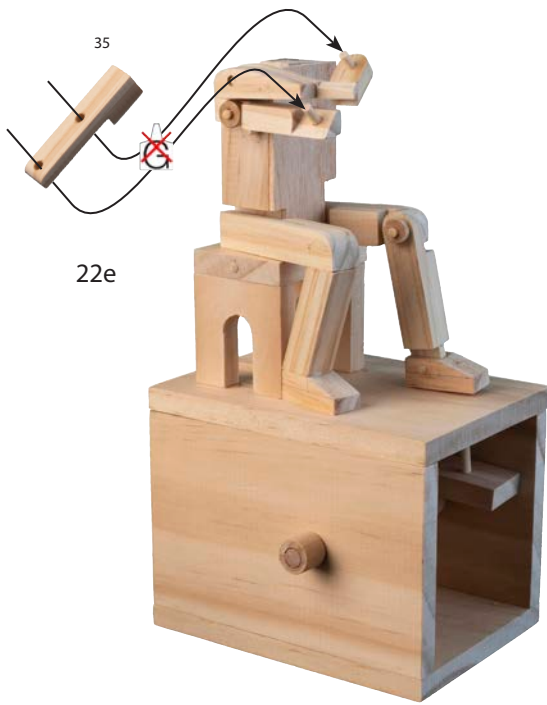

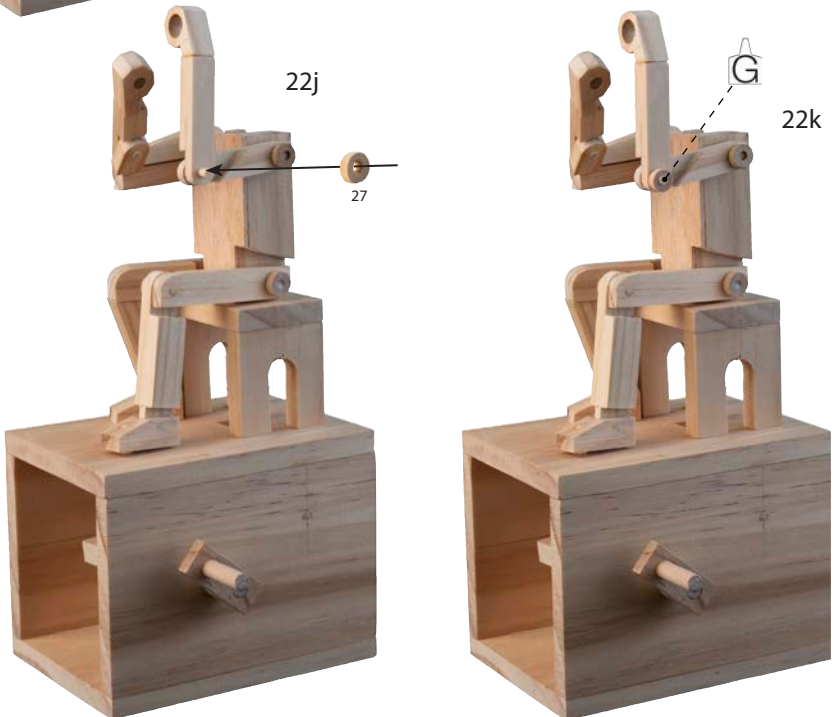
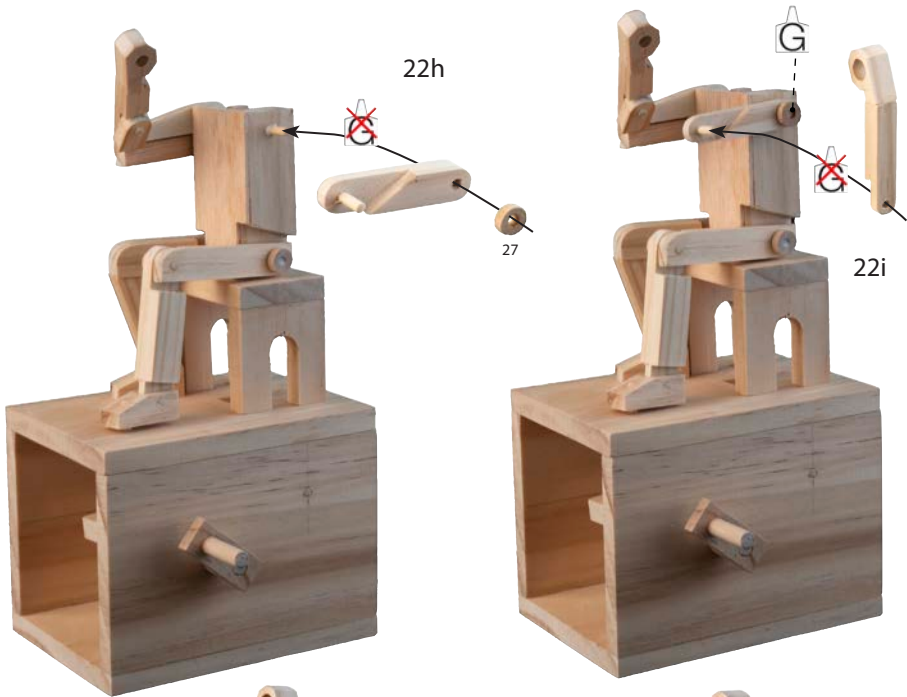

23

23a

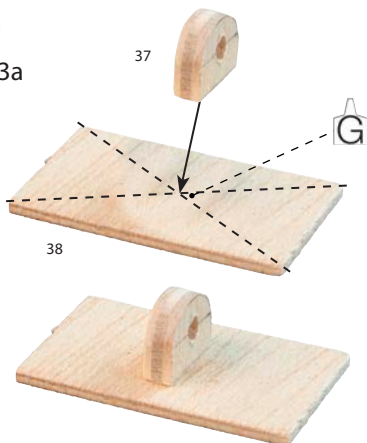

23b

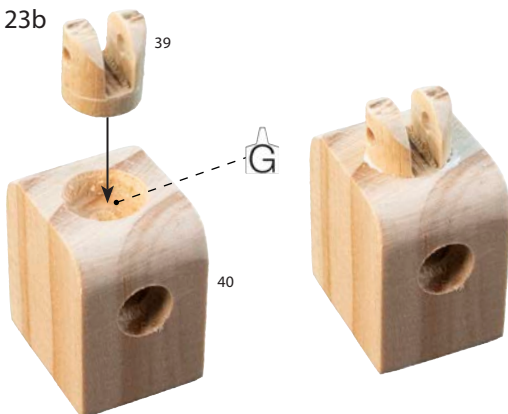

23c

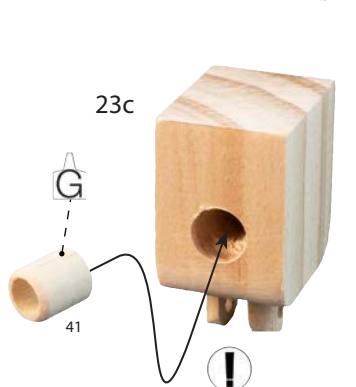

Put glue on outer rim of part #41 only and push in place into part #40

23d

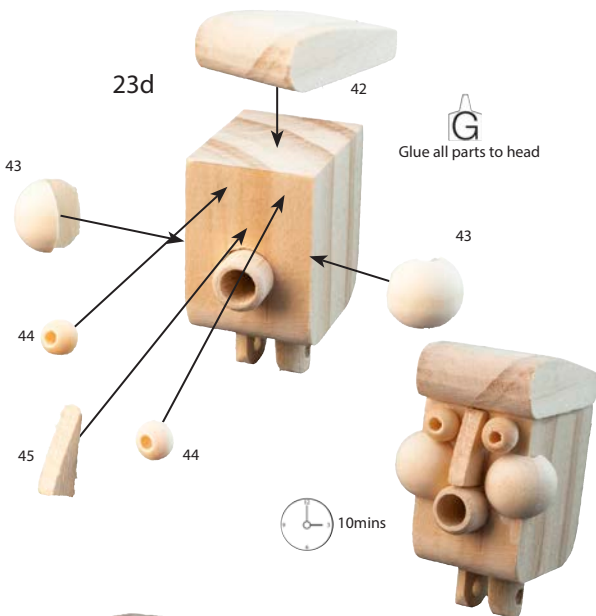

23e

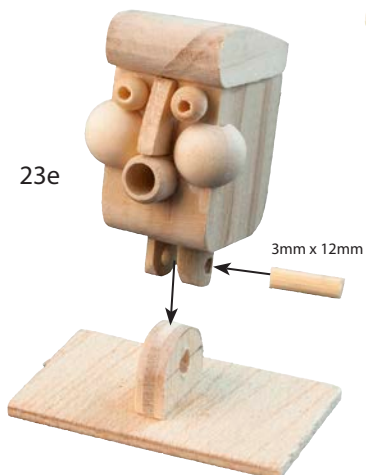

23f

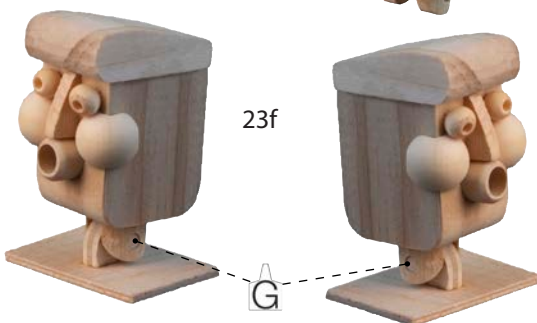

24

When gluing head and shoulders to the torso ensure a bead of glue is applied to the top left shoulder only. Ensure no glue is accidentally goes on to the top of the waggle stick.



25

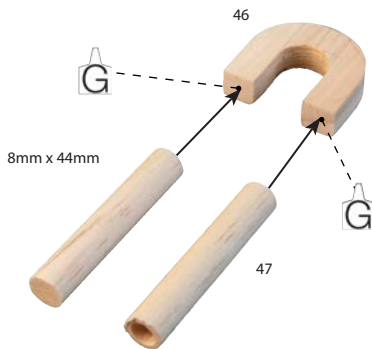

26

26d

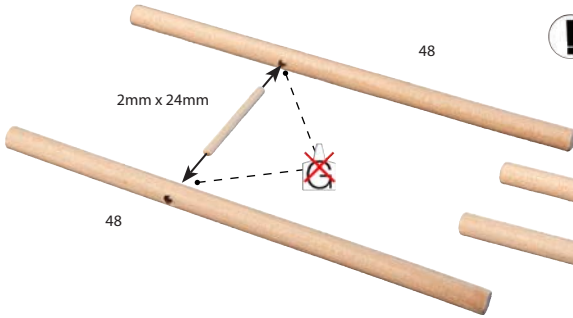

The peg 2mm x 24mm is used to ensure the space is correct when gluing the two parts #48 to part #49



26b



26c

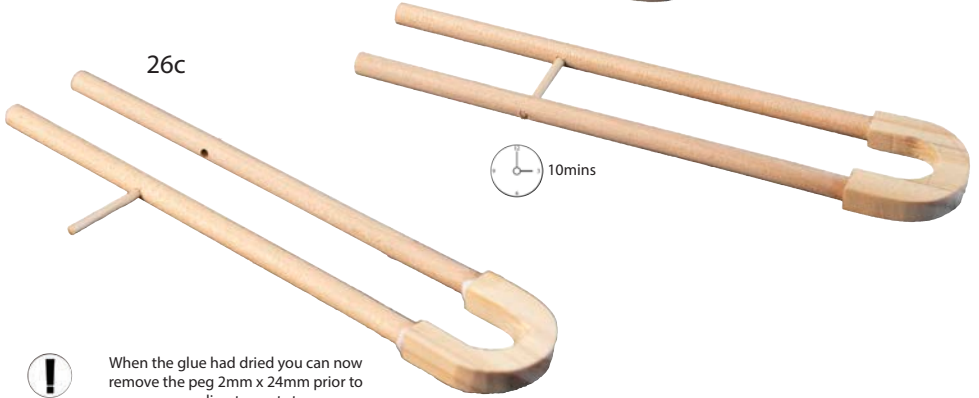

When the glue had dried you can now remove the peg 2mm x 24mm prior to proceeding to next step.





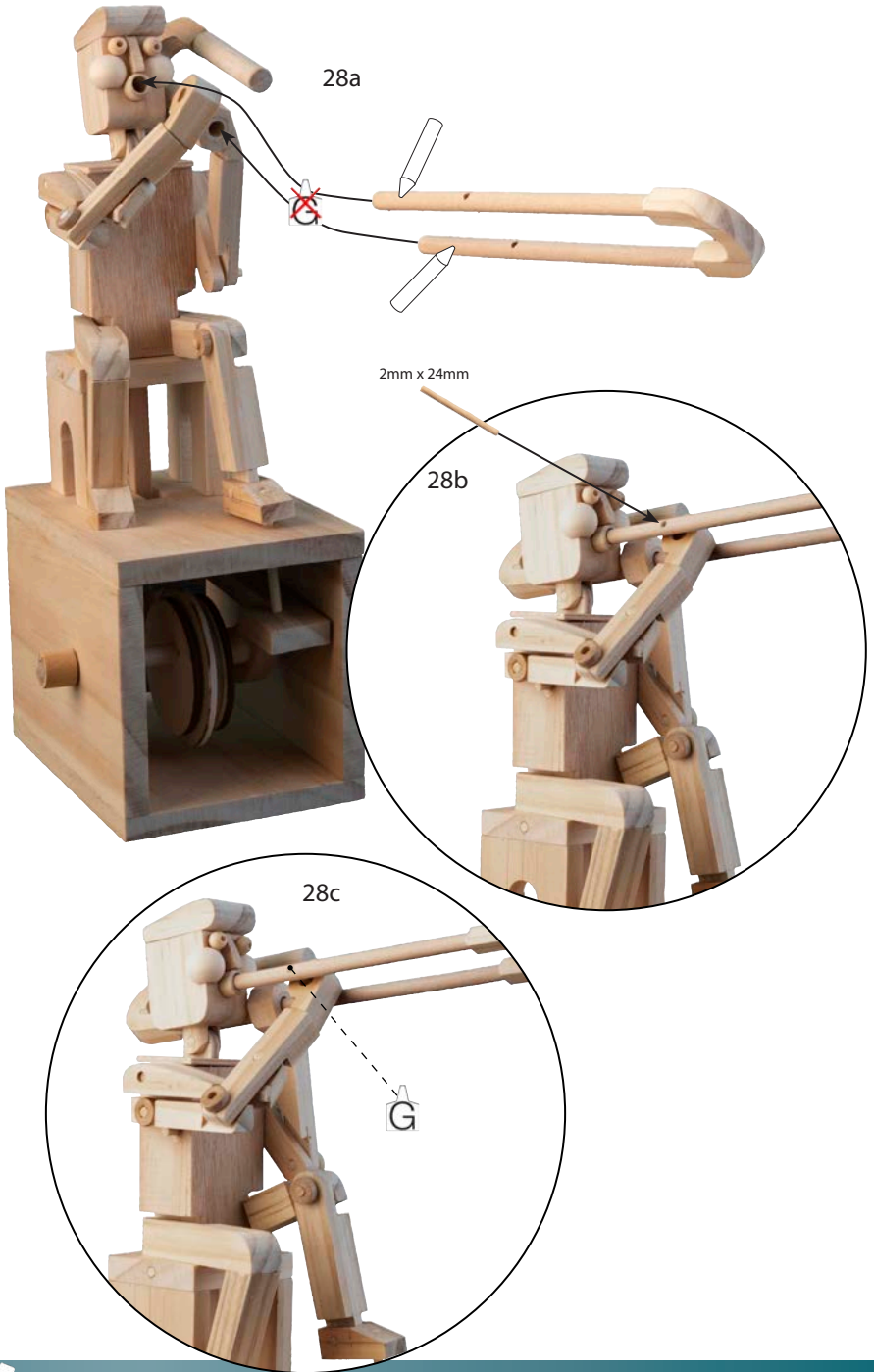

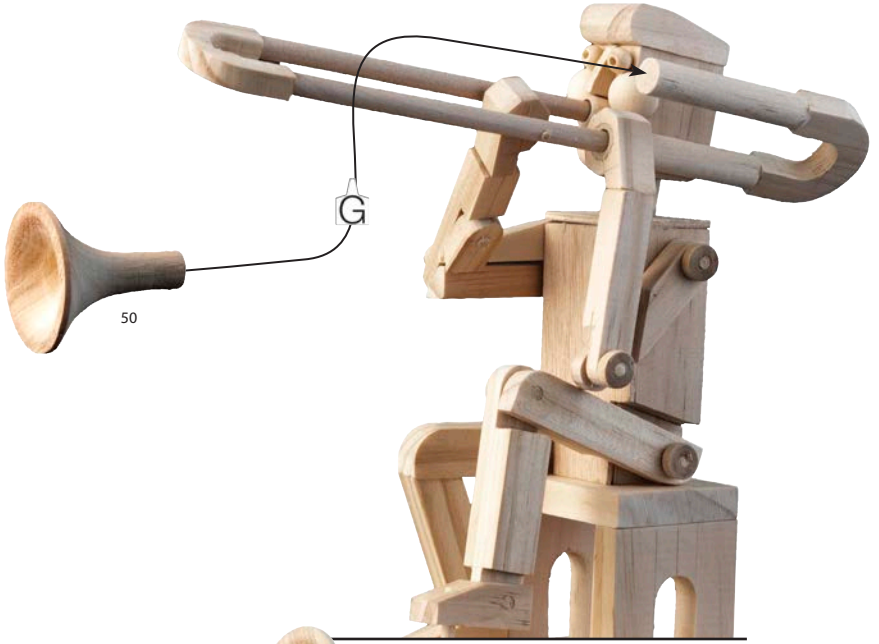



(UK) If you enjoyed building this model why not try our others. Available directly from Timberkits Ltd or from our UK, European or worldwide retail partners. Check our website to find your nearest stockist.

(FR) Si vous avez apprécié construire ce modèle, pourquoi ne pas en essayer d'autres. Ils sont disponibles chez Timberkits Ltd ou chez nos partenaires détaillants au Royaume Uni, en Europe et plus largement dans le monde.

(SP) Si te has divertido con este modelo, porque no pruebas los demás. Están todos disponibles directamente desde Timberkit Ltd o desde nuestras tiendas en Reino Unido, Europa o en otros continentes. Visita el nuestro sitio web para conocer el punto de venta más cercano.

(IT) Se ti sei entusiasmato a costruire questo modello, perché non provare gli altri. Sono disponibili direttamente dalla Timberkits Ltd oppure dai nostri rivenditori in Gran Bretagna, Europa e altri continenti. Visita il nostro sito web per trovare il più vicino punto vendita.

(DE) Wenn sie Freude daran hatten, dieses Modell zu bauen, wieso nicht die anderen ausprobieren. Sie können direkt bei Timberkits Ltd bestellen oder bei unseren Handelspartnern in Großbritannien, Europa und weltweit. Besuchen sie unsere Webseite für ihren nächstgelegenen Händler.

www.timberkits.com

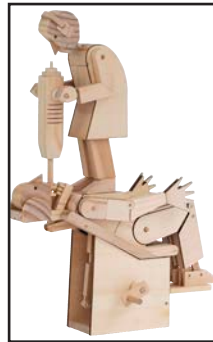



Timberkits Limited
Old Village Hall
Llanbrynmair
Powys, SY19 7AA
00 (44) (0) 1650 521635
timber_kits@btconnect.com
www.timberkits.com

Timberkits logo and all Timberkits designs are Copyright (©) 2014 all rights reserved.

