



Code 107672

Original Instructions

AW300DS

300mm Disc Sander



AT: 09/02/2022
BOOK VERSION: 4

Index of Contents

EU Declaration of Conformity	02
What's in the Box	03
General Instructions for 230V Machines	04
Specific to Sanding Machines	05-06
Assembly	07-08-09
Specifications	10
Parts Illustration and Description	11
Changing the Sanding Disc	12
Maintenance	12
Exploded Diagrams/Lists	13-14
Notes	15

EU Declaration of Conformity

<p>Cert No: DS12 (Disc Sander)</p> <p>Axminster Tool Centre Ltd Axminster Devon EX13 5PH UK axminstertools.com</p> <p>declares that the machinery described:-</p> <table border="1"> <tr> <td>Type</td> <td>Disc Sander</td> </tr> <tr> <td>Model</td> <td>AW300DS</td> </tr> </table> <p>Signed </p> <p>Andrew Parkhouse Operations Director</p> <p>Date: 15/05/2020</p>	Type	Disc Sander	Model	AW300DS	<p>EU Declaration of Conformity</p> <p>This machine complies with the following directives:</p> <table border="1"> <tr> <td>2014/30/EU EN 61000-3-3:2013+A1 EN IEC 61000-3-2:2019 EN 55014-2:2015</td> <td>EN 55014-1:2017</td> </tr> </table> <p>conforms to the machinery example for which the EC Type-Examination Certificate No AE 50467891 has been issued by Laizhou Chunlin Machinery Co., Ltd. at: No.269 Baoshi Road, Wenfeng Street, Laizhou City, 261400 Shandong, China (Mainland) and complies with the relevant essential health and safety requirements.</p>	2014/30/EU EN 61000-3-3:2013+A1 EN IEC 61000-3-2:2019 EN 55014-2:2015	EN 55014-1:2017
Type	Disc Sander						
Model	AW300DS						
2014/30/EU EN 61000-3-3:2013+A1 EN IEC 61000-3-2:2019 EN 55014-2:2015	EN 55014-1:2017						

The symbols below advise the correct safety procedures when using this machine.



Fully read manual and safety instructions before use



Ear protection should be worn



Eye protection should be worn



Dust mask should be worn



HAZARD
Motor gets hot

Model Number

AW300DS

Box Containing:

1 No. 300mm Disc Sander (Sanding Disc & Table Fitting)

1 No. Flexible Extraction Hose.

Bag 1 Containing:

2 No. Moulded Lift & Shift Locking Handles

2 No. Locking Handle Spring/Screws

Bag 1 Containing:

1 No. Mitre Fence

1 No. Instruction Manual

Having opened the box, remove all the components stowed in the packaging. Place these carefully to one side. Remove the top packaging and lift the machine out of the box and place upon a clear flat surface, taking care not to trap or pinch the power cable under the chassis. Remove any other items from the box.

Having unpacked your sander and its various components, if you do not wish to retain the packaging please dispose of it responsibly, especially any polystyrene; most of the rest of the packaging is biodegradable.

NOTE: Please read the Instruction Manual prior to using your new machine; as well as the operating procedures for your new machine, there are numerous hints and tips to help you to use the machine safely and to maintain its efficiency and prolong its life.

Keep this Instruction Manual readily accessible for any others who may also be required to use the machine.

General Instructions for 230V Machines

The following will enable you to observe good working practices, keep yourself and fellow workers safe and maintain your tools and equipment in good working order.



WARNING!! KEEP TOOLS AND EQUIPMENT OUT OF REACH OF YOUNG CHILDREN.



KEEP WORK AREA AS UNCLUTTERED AS IS PRACTICAL. UNDER NO CIRCUMSTANCES SHOULD CHILDREN BE ALLOWED IN WORK AREAS.

Mains Powered Tools

- Tools are supplied with an attached 13 Amp plug.
- Inspect the cable and plug to ensure that neither are damaged. Repair if necessary by a suitably qualified person.
- Do not use when or where it is liable to get wet.

Workplace

- Do not use 230V a.c. powered tools anywhere within a site area that is flooded.
- Keep machine clean.
- Leave machine unplugged until work is about to commence.

- Always disconnect by pulling on the plug body and not the cable.
- Carry out a final check e.g. check the cutting tool is securely tightened in the machine and the correct speed and function set.
- Ensure you are comfortable before you start work, balanced, not reaching etc.
- Wear appropriate safety clothing, goggles, gloves, masks etc. Wear ear defenders at all times.
- If you have long hair wear a hair net or helmet to prevent it being caught up in the rotating parts of the machine.
- Consideration should be given to the removal of rings and wristwatches.
- Consideration should also be given to non-slip footwear etc.
- If another person is to use the machine, ensure they are suitably qualified to use it.
- Do not use the machine if you are tired or distracted
- Do not use this machine within the designated safety areas of flammable liquid stores or in areas where there may be volatile gases.
- Check cutters are correct type and size, are undamaged and are kept clean and sharp, this will maintain their operating performance and lessen the loading on the machine.
- OBSERVE.... make sure you know what is happening around you and USE YOUR COMMON SENSE.



WARNING! THE SANDING DISC CANNOT BE DECLUTCHED FROM THE BELT AND VICE VERSA, BOTH FUNCTIONS ARE ACTIVE WHEN THE MACHINE IS RUNNING. REMEMBER THIS, AND DO NOT LEAVE LOOSE OBJECTS OF ANY DESCRIPTION, ON THE MACHINE IF IT IS GOING TO BE USED.

Once the sander is mounted, carry out any setting operations, (mitre, tilt...), and remove all tools used in the setting operations (if any) and place safely out of the way. If you are working long lengths of material arrange for extra support beyond the boundary of the machine, and check you have sufficient room to manoeuvre the material through all the operations you will wish to carry out.

It is good practice to leave the machine unplugged until work is about to commence, also make sure to unplug the machine when it is not in use. Always disconnect by pulling on the plug body and not the cable.

After fitting a new sanding disc, it is good practice to lightly sand across the left side of the disc with a reasonable sized (20mm x 50mm) piece of timber to make sure the sanding disc is correctly 'seated' on the disc. The sanding action will press the sanding disc firmly back against the disc itself.

It is not good practice to wear gloves whilst sanding as one tends to lose the 'feel' of the workpiece/sander contact, but obviously this removes the safety barrier between your fingers and the sanding surface. Remain focused and exercise caution whilst sanding.

DO NOT sand very small pieces of work with bare hands; try to construct some form of holder.

MAKE SURE you are comfortable before you start work, balanced, not reaching etc.

If the work you are carrying out is liable to generate excessive grit or dust or chips, wear the appropriate safety clothing, goggles, masks etc., If the work operation appears to be excessively noisy, wear ear-defenders. If you wear your hair in a long style, wearing a cap, safety helmet, hairnet, even a sweatband, will minimise the possibility of your hair being caught up in the rotating parts of the machine, likewise, consideration should be given to the removal of rings and wristwatches, if these are liable to be a 'snag' hazard.

DO NOT work with cutting/abrasive tools of any description if you are tired, your attention is wandering or you are being subjected to distraction. A deep graze, a lost fingertip or worse, is not worth it!

DO NOT use the machine within the designated safety areas of flammable liquid stores or in areas where there may be volatile gases. There are very expensive, very specialised machines for working in these areas, **THIS IS NOT ONE OF THEM.**

CHECK that sanding surfaces are still sufficiently abrasive to carry out the work you intend. Sanding belt cleaning sticks are an efficient method of prolonging the life of the belts and discs, and will also maintain their operating performance.

Continues Over...

Specific to Sanding Machines

CHECK that the belts or discs are undamaged; torn edges can pick up on the workpiece and will cause the medium to tear, often very rapidly with accompanying sharp flapping edges.

ALWAYS offer the workpiece to the belt/disc so that the motion carries the work against the restraining surface, (i.e. the work stop or the table, (use the left hand side of the disc).

DO NOT press too heavily against the sanding surface, all this will do is slow the sander down. Remember, sanders work by removing small particles of material quickly and heavy pressure works adversely to the cutting process, further, it will accelerate the rate of 'clogging' of the abrasive surfaces, rendering the machine less efficient.

If you are attempting to sand inside curves (over the 'tracking drum') do not press at all,

other than to keep the workpiece in contact with the surface, any pressure could upset the tracking geometry. As there is no cushioning effect to the belt passing around the drum, expect an added vibration and compensate for it.

Sanding of certain types of timber may make the fitting of dust extraction mandatory in order to comply with the directives of the HSE. However, even if it is not mandatory, it is strongly recommended that you consider fitting dust extraction. It will certainly reduce the level of dust and grit, and as it helps to remove the waste quicker will certainly prolong the longevity of the abrasive.

Above all, **OBSERVE....** make sure you know what is happening around you, and **USE YOUR COMMON SENSE.**

In order to reduce the footprint of the machine for packaging, several items are dismantled from the machine and need to be re-affixed.

Locate the two moulded locking handles and the two spring/screws, insert the handles over the table swivel studs one on either side of the table (See fig 1).

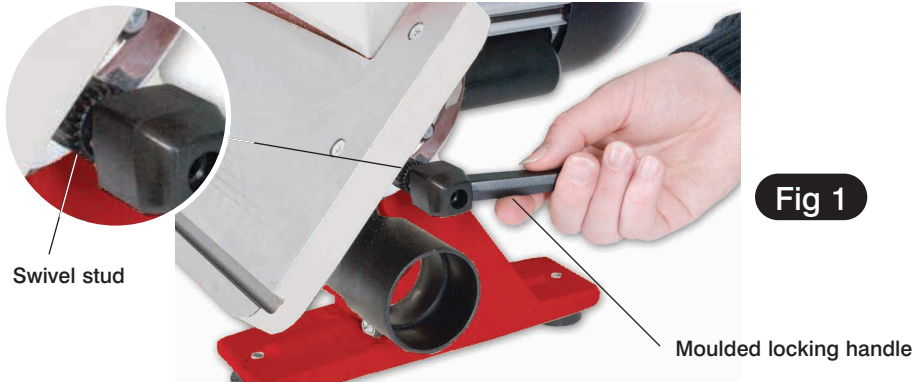

Introduce and screw the spring/screw through the locking handle into the swivel stud using a screwdriver (See figs 2-3)

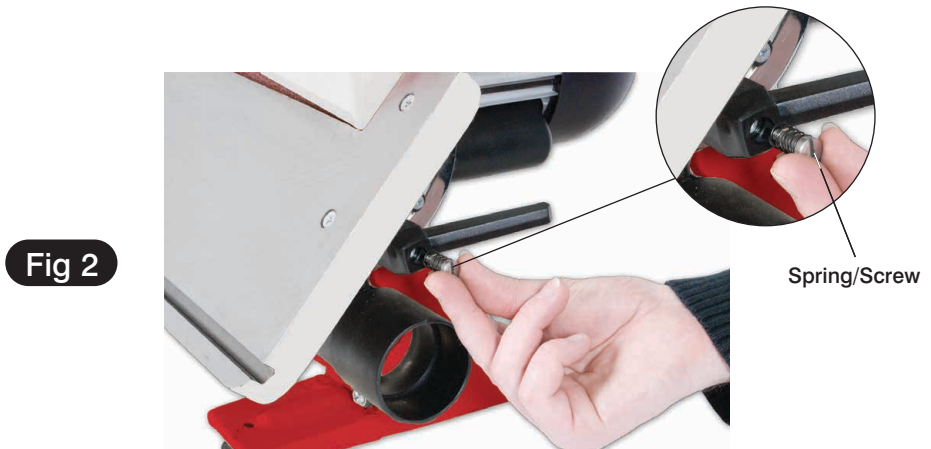
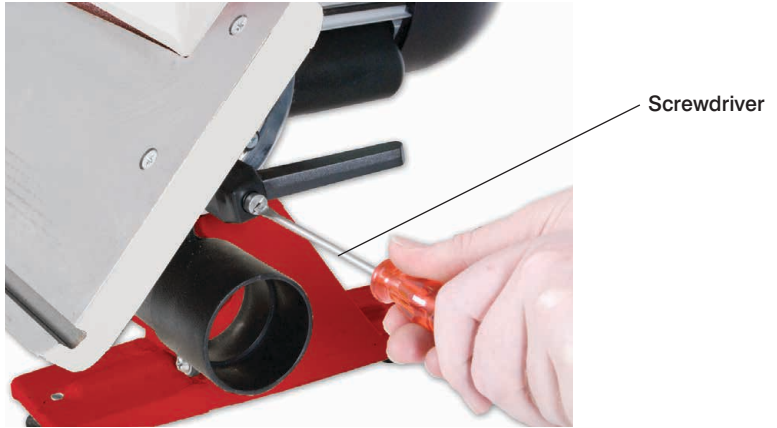
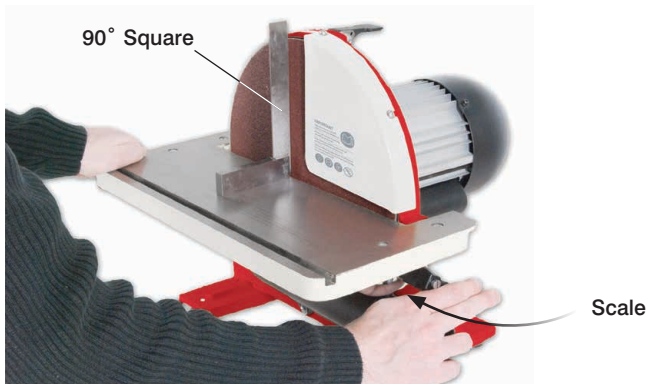

Fig 3



Lift the table until the scale pointer reads 90° degrees on the scale, place a 90° degrees square on top of the table and adjust until both table and sanding disc are at 90° degrees, then clamp the table in position by pulling the locking handles down. (See fig 4)

Fig 4



Locate the mitre fence and slide it into the “T” slot machined into the table. (See fig 5)



Fig 5

Locate the flexible extraction hose and fit one end of the hose over the dust extraction outlet, push firmly home. (See fig 6) The other end of the hose can be attached to a dust extraction system. The Sander is ready for use.

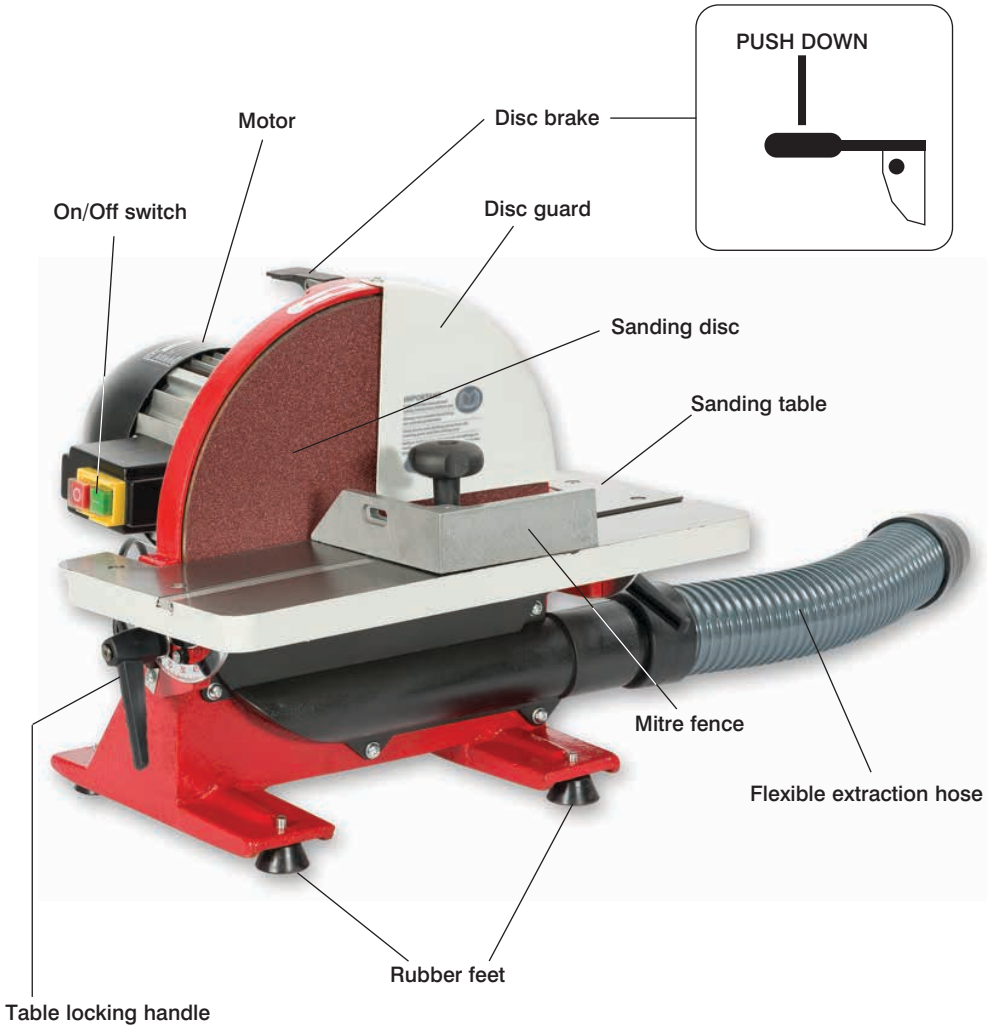

Fig 6

Specification

Code	107672
Model	AW300DS
Rating	Workshop
Power	750W 230V 1ph
Speed	1,420rpm
Diameter of Disc	300 mm
Table Size	445 x 155 mm
Table Tilt	45°
Dust Extraction Outlet	63 mm
Overall L x W x H	500 x 470 x 420 mm
Weight	30 kg

Parts Illustration and Description



Changing the Sanding Disc



DISCONNECT THE MACHINE FROM THE MAINS SUPPLY!

1. Remove the sanding disc guard by removing the two Phillips screws on top of the guard.
2. Remove the two locking handles on either side of the sander.
3. Remove the swivel studs and lift the table away.
4. Lift the edge of the disc and, gripping firmly, peel the disc away from the plate; turning the plate as required to free the entire disc.
5. Remove and throw away. If you have been extremely fortunate all the adhesive will have been removed with the disc. As this is rarely the case, be prepared to rub, scrape, pick etc.,
6. Clean the surface of the disc with a degreasing cleaner. Allow to dry off and wipe over with a clean dry cloth. Locate the sanding disc, peel the cover from the adhesive surface and apply **CAREFULLY** to the disc. Use a piece of cloth in your hand or wear a glove, to firmly press the abrasive to the disc, the application will be reinforced by a gentle sanding action across the face when you first use the new sanding disc.
7. Replace the table and guard as described above, in reverse and continue operation.

Maintenance



DISCONNECT THE MACHINE FROM THE MAINS SUPPLY!

There is very little mechanical maintenance that can be carried out on the machine. Most prudent maintenance is preventative and concerned with keeping the machine clean.

Inspect and remove all dust/resin build ups, and blow the motor clean.

Remove the sanding disc guard, remove any build ups and clean them thoroughly to allow the dust to travel over their surfaces smoothly.

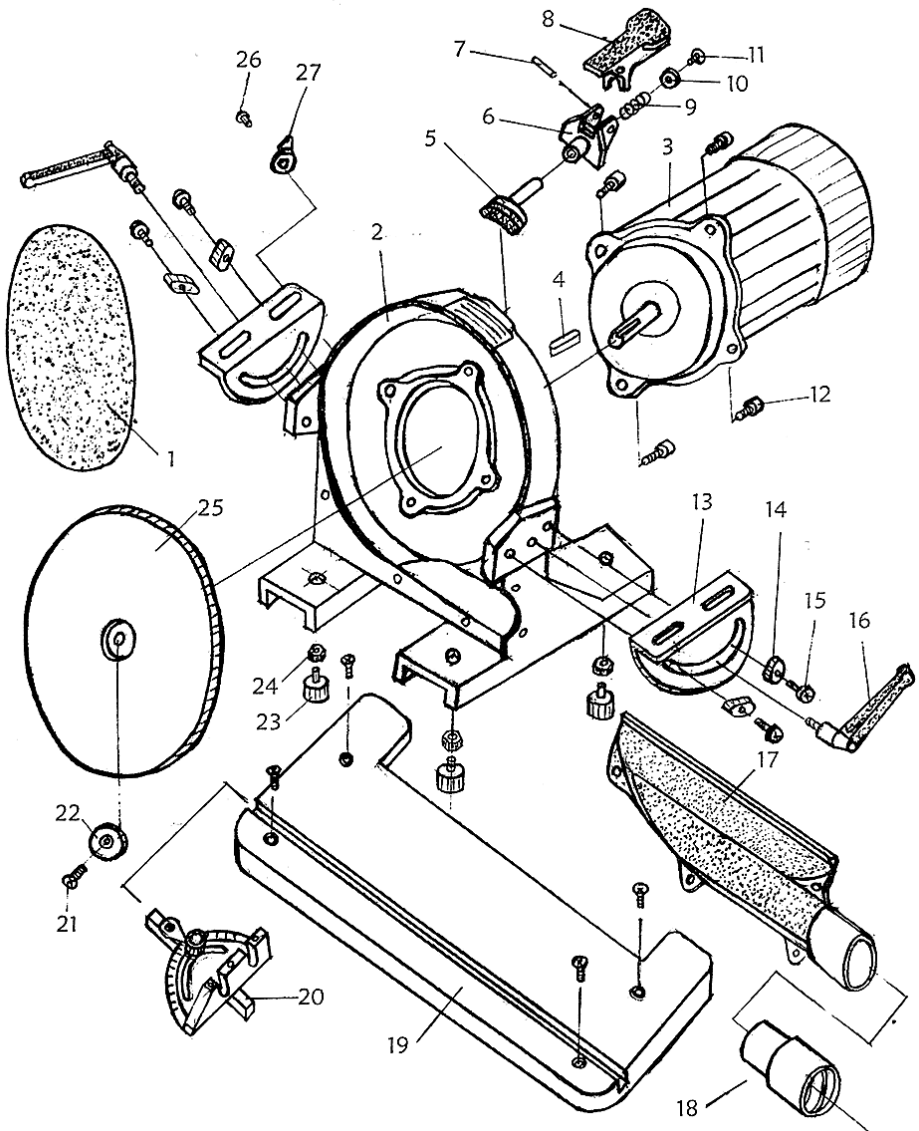

Exploded Diagrams/Lists

Item	Description	Specification	Qty
01	Sanding Disc	300mm	1
02	Base		1
03	Motor		1
04	Key	A5 x25	1
05	Brake Base		1
06	Brake Frame		1
07	Pin		1
08	Handle		1
09	Spring		1
10	Washer		1
11	Screw	M5 x 10	1
12	Hex Headbolt		4
13	Trunion		2
14	Reference washer		2

Item	Description	Specification	Qty
15	Pan Head Bolt		4
16	Lock Assembly		2
17	Disc Cover Outlet		1
18	Dust Extraction Outlet adaptor		1
19	Table		1
20	Mitre Fence		1
21	Screw		1
22	Washer		1
23	Rubber Foot		4
24	Hex Nut	M8	4
25	Disc Assembly		1
26	Washer		1
27	Scale Pointer		1

The Axminster guarantee

Buy with confidence from Axminster!

So sure are we of the quality, we cover all parts and labour free of charge for three years!



For more information visit axminstertools.com/3years



The packaging is suitable for recycling.
Please dispose of it in a responsible manner.



EU Countries Only

Do not dispose of electric tools together with household waste material.
By law they must be collected and recycled separately.



Axminster Tools, Axminster Devon EX13 5PH

axminstertools.com