

Guide for fitting the Extension Table for AP2920B & AP3600B Bandsaws



Machines from mid to late 2023 may need 4 holes drilling to accept the rear extension table.

Code: 109981

Marking the holes

- First step is to apply a strip of masking tape to the rear of the cast iron table, this will make the drilling marks more visible



- Mark an 18mm line along the full length of the table from the top of the table



- Facing the rear of the table and working from the left-hand side mark off at 52.5mm - then - 90mm - then 250mm - then 90mm as in diagram below

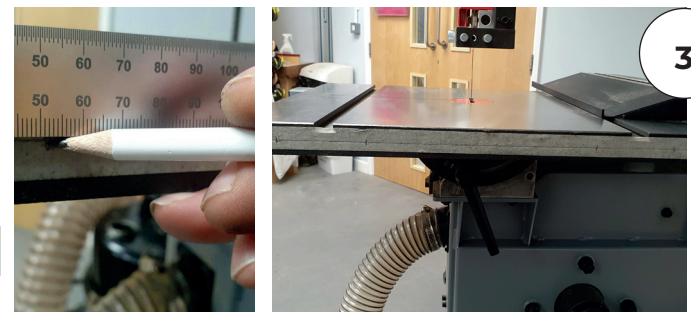
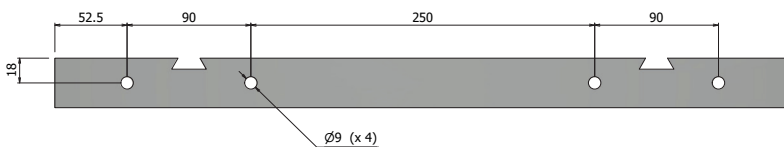

Drilling

- Before drilling ensure that the bandsaw motor is covered to prevent metal particles entering the motor
- On each of the marks drill a 3mm or 4mm pilot hole ensuring that the hole is drilled straight & square



- Open the drilled holes to a 9mm or 10mm hole again ensuring the drilled hole is straight & square



- Remove the masking tape

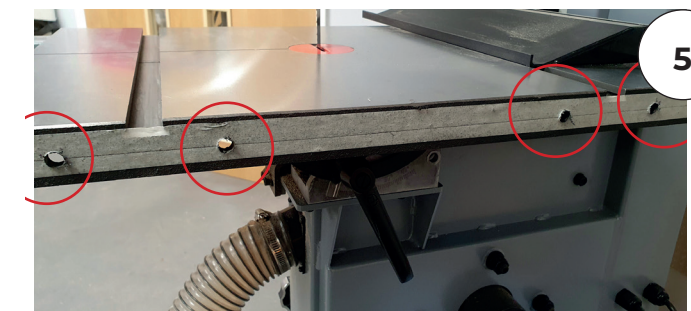

Continued overleaf...

Fitting

- Align table to holes

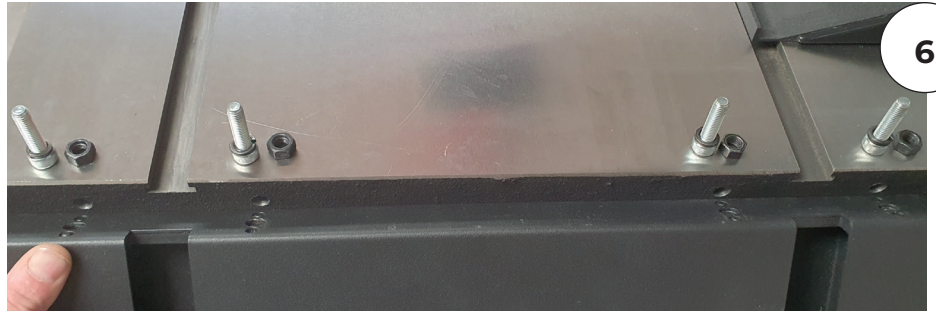

- Bolt through with M8 x 30 cap head bolts
- Tighten loosely

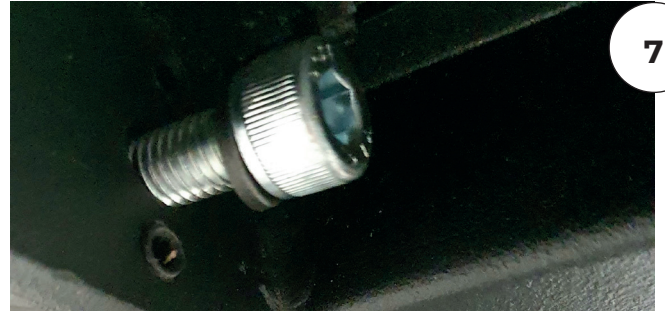

Levelling

- Place a Straight edge on main table & extension table



- Use 2 levelling grub screws next to each of the bolts to approximately level with main saw table



- Ensure that the extension table is never higher than the main table

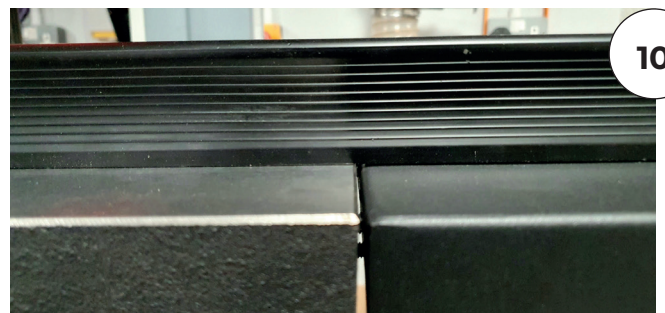

- Bolt firmly into position, then recheck level & readjust if needed

