

Step-by-step guide to...

GOLD PLATED LETTER CLIP

Order Code:
202157

Difficulty Level : Beginner



1. Hold between centres and in this case, I'm using a pro drive centre and a live ring centre.

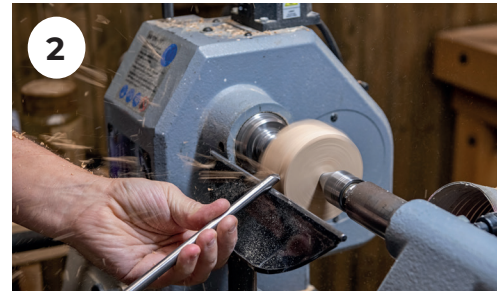

2. Rough your blank down to a cylinder with a bowl gouge to 70mm.



3. Measure your jaws internal measurement and for this project I'm using the O'Donnell which measure 40mm internally.



4. Cut a tenon on the face of your blank to measure your jaws dimension.



5. Refine the tenon to suit your chuck jaws, in the case of the O'Donnell jaws this is a dovetail.



6. Turn your blank over and mount into your chuck.



7. Now measure the external grip of your jaw in preparation to turn a recess.



8. Tidy the face of your blank with a bowl gouge.



9. Now mark your recess diameter.



10. Cut in the recess diameter with a parting tool.



11. Cut the rest of the waist from the recess with a small bowl gouge.



12. Refine the recess to a dovetail with a skew chisel.



13. Decorate the recess as an added feature.



14. Measure the screw length that holds the pen nib in place, this screw needs to be sunk into the base but still protrude enough thread to hold the pen, if unsure just follow the attached plan. Mark a 10mm drill to length.



15. Hold the drill bit in a drill chuck mounted in the tailstock and drill to your mark.



16. Now drill all the way through the blank with a 4mm drill bit to allow the thread of the screw to pass all the way through.



17. The base can now be sanded to a finish.



18. I'm using finishing oil to finish my base which is applied with a polishing cloth then burnished in with a dry polishing cloth until dry.



19. Double check your 10mm measurement with a depth gauge and mark this on the outside of the base. Hold the screw against the measurement to make sure all is correct and if not, it can be corrected on the front face.



20. Holding the blank via its recessed base, turn down to the finished thickness.



21. Once the important measurements have been turned you can have some fun with the shaping, I'm using an Ogee design on mine which has a nice convex turning into a concave at the bottom.



22. Sand to a good finish.



23. Oil the finished surface and buff with polishing cloth.

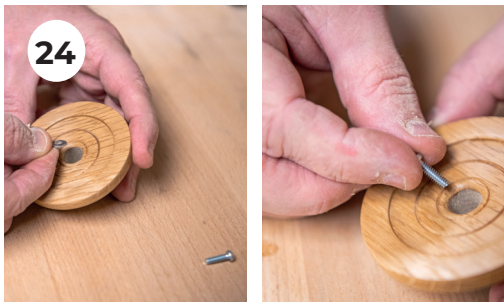

24. Remove from the chuck and insert the washer and screw.



25. Screw the paper clip onto the base.



26. There we are, the finished Letter Clip.